

MICHIGAN

PARTS MANUAL

No. 1469

MODEL 210 TRACTOR WAGON (REAR DUMP)

Information contained herein pertains to Tractor Wagon (Rear Dump Section) only on Machine Serial Numbers 70US thru 70U12.

Tractor Wagon (Tractor Section) See Parts Manual No. 1392.

Tractor Scraper (Body Section) See Parts Manual No. 1475.

Record Your Machine
Serial Number Here



CLARK EQUIPMENT COMPANY
Construction Machinery Division
BENTON HARBOR, MICHIGAN, U.S.A.
In Canada: Canadian Clark, Ltd., St. Thomas, Ontario

The word "MICHIGAN" in a bold, sans-serif font, centered within a black rectangular background.

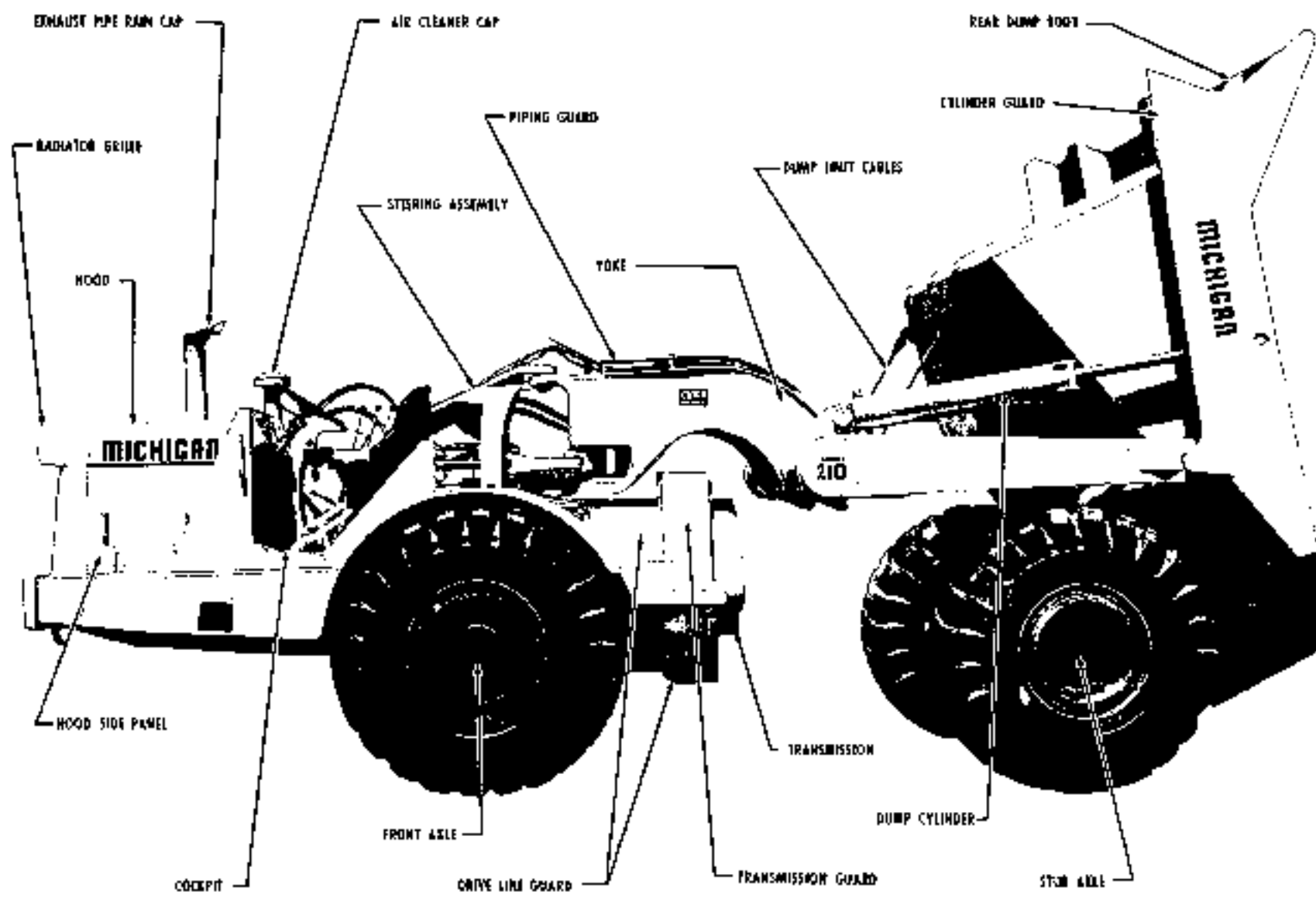

MODEL 210 TRACTOR WAGON (Rear Dump)

WHEN ORDERING REPAIR PARTS

To assure the best results and to maintain the original quality built into the machine it is important that genuine "Clark" Parts be used when new parts are required.

IMPORTANT: Always furnish the distributor with the machine serial number when ordering parts.

Order through your nearest Clark Distributor, for THE MICHIGAN LINE.

Always give serial number of machine.

Furnish Quantity, Part Number and Description.

WHEN PARTS ARE RECEIVED

Check immediately for quantity, correctness and condition.

Advise your Michigan Distributor of any error.

Claims for damages, during shipment, should be made to the carrier, immediately.

INDEX MODEL 210 TRACTOR WAGON (Rear Dump)

This index covers the Tractor Wagon (Rear Dump) Section only. Refer to Parts Manual No. 1392 for Tractor Section parts of Model 210 Tractor Wagon that are not covered in this index.

A	Page		Page
Air Chamber - Rear Brake.....	4	Dump Cylinder	11
Air Compressor Governor	7	Dump Hydraulic System	10
Air Lines - Rear Dump.....	5	Dump Limit Cable, Bowl	1
Air Lines - Tractor (Rear Dump).....	7		
Axle - Rear Dump Stub.....	3	G	
		Governor, Air Compressor	7
B			
Bowl Assembly and Dump Limit Cables.....	1	H	
Brake Air Chamber - Rear.....	4	Hydraulic Cylinder, Dump	11
Brake Air Lines - Rear Dump.....	5	Hydraulic System, Dump	10
Brake Air Lines - Tractor (Rear Dump)	7		
Brake Assembly - Rear	4	R	
Brake Hand Valve	7	Rock Guards.....	13
Brake Slack Adjuster	4		
		T	
C		Tools	13
Cable, Dump Limit	1	Transmission and Drive Shaft Rock Guards.....	13
Chamber, Air Brake - Rear	4		
Control Valve, Rear Dump	9	Y	
Cylinder, Dump	11	Valve, Rear Dump Control.....	9
D		W	
Decals	13	Wheel and Tire Data	12
Drive Shaft Rock Guards.....	13		
		Y	
		Yoke, Rear Dump	2



NOTES

A series of horizontal lines providing space for handwritten notes.

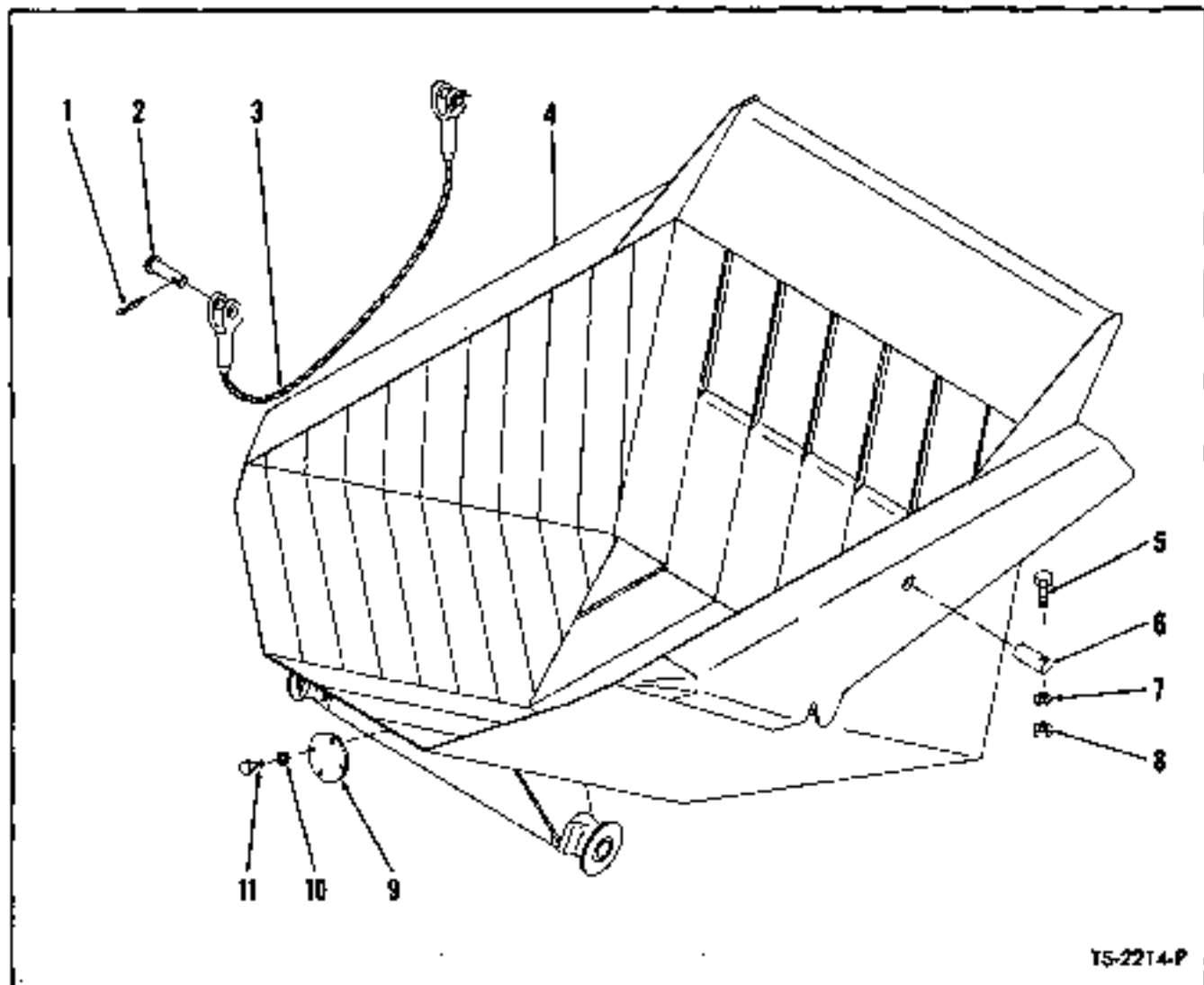

Y5-2214-P

BOWL ASSEMBLY AND DUMP LIMIT CABLE

Item No.	Part No.	Description	No. Req'd.
1	1F-1040	COTTER, Cable Pin.....	4
2	944671	PIN, Cable Attaching	4
3	582066	CABLE, Dump Limit (Inc. 1, 2)	2
4	593917	BOWL ASSY, Rear Dump.....	1
5	2C-10112	BOLT, Pin Retaining.....	2
6	594019	PIN, Cylinder to Bowl	2
7	4E-10	WASHR, Pin Retaining.....	2
8	2D-10	NUT, Pin Retaining	2
9	593737	PLATE, Bowl Cover.....	1
10	4E-06	WASHR, Cover Plate	4
11	2C-616	BOLT, Cover Plate.....	4

WHEN ORDERING PARTS, ALWAYS STATE MODEL AND SERIAL NO. OF MACHINE

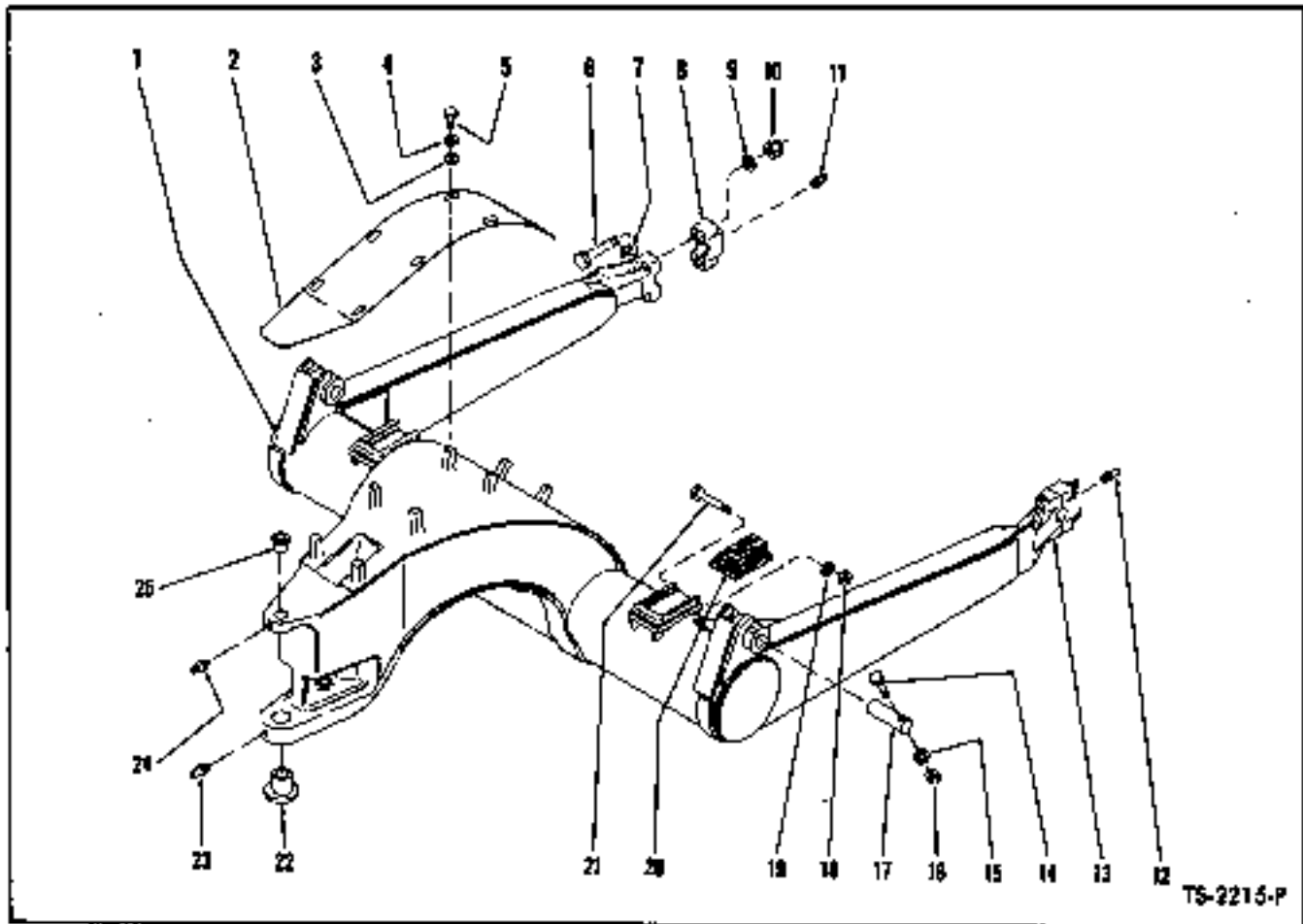

TS-2215-P

YOKE ASSEMBLY

Item No.	Part No.	Description	No. Req'd.
1	594390	YOKE ASSY (Inc. & thru 9, 11, 20, 23)	1
2	580887	PLATE, Cover	1
3	619027	WASHER, Cover Plate	8
4	4E-08	LOCKWASHER, Cover Plate	8
5	2C-816	BOLT, Cover Plate	8
6	24C-20144	BOLT, Trunnion Bearing	4
7	583002	WASHER, Trunnion Bearing	1
8	580799	CAP, Trunnion Bearing	2
9	583002	WASHER, Trunnion Bearing	1
10	68D-20	NUT, Trunnion Bearing	4
11	10H-25	FITTING, Trunnion Bearing Grease	1
12	10H-25	FITTING, Trunnion Bearing Grease	1
13	580797	BEARING ASSY, Trunnion (Inc. & 7, 8)	2
14	2C-10112	BOLT, Pin Retaining	2
15	4E-10	LOCKWASHER, Pin Retaining	2
16	2D-10	NUT, Pin Retaining	2
17	590708	PIN, Cylinder to Yoke	2
18	2D-06	NUT, Block Retaining	2
19	4E-06	LOCKWASHER, Block Retaining	2
20	592908	BLOCK, Body Stop	2
21	14C-6136	BOLT, Block Retaining	2
22	592785	BUSHING, Lower Yoke	1
23	10H-25	FITTING, Yoke Grease	1
24	10H-25	FITTING, Yoke Grease	1
25	591623	BUSHING, Upper Yoke	1

WHEN ORDERING PARTS, ALWAYS STATE MODEL AND SERIAL NO. OF MACHINE

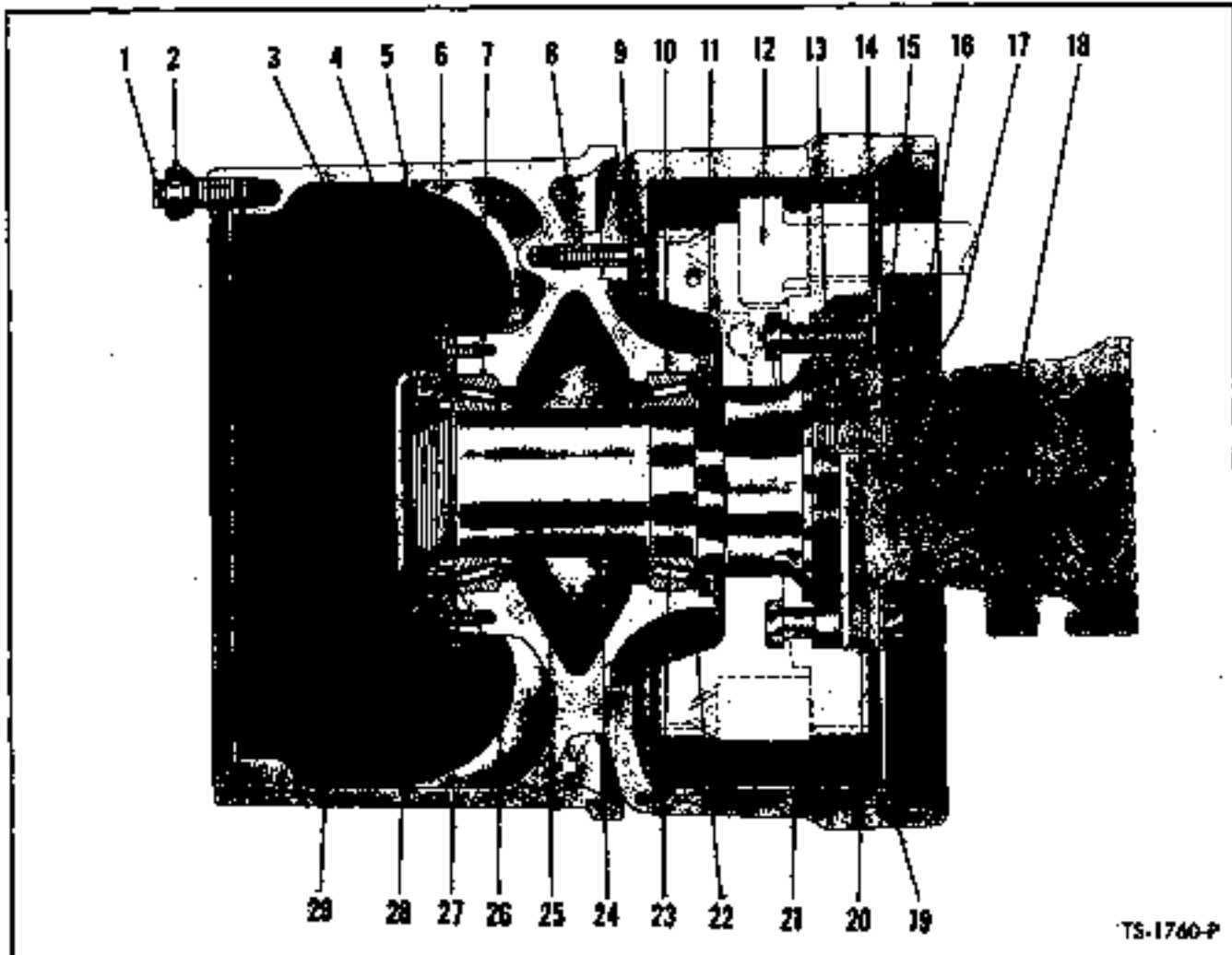

TS-1760-P

STUB AXLE

Item No.	Part No.	Description	No. Req'd	Item No.	Part No.	Description	No. Req'd
1	109137	STUD, Wheel	32	16	4E-06	LKWSHR, Dust Cover	12
2	107983	NUT, Wheel	32	17	1C-630	BOLT, Dust Cover	12
3	107729	NUT, Spindle - Outer	2	18		Part of Bowl	
4	107730	LOCK, Spindle Nut	2	19	106477	COVER, Dust	4
5	1C-718	BOLT, Hub Cap	12	20	655673	SPACER, Dust Cover	6
6	4E-07	LKWSHR, Hub Cap	12	21	108464	DRUM, Brake	2
7	742262	CUP, Outer Hub Bearing	2	22	107983	CATCHER, OIL	2
8	111461	BOLT, Drum to Hub	24	23	742263	CONE, Inner Hub Bearing	2
9	111656	WASHER, Drum to Hub	24	24	108498	SPINDLE	2
10	742262	CUP, Inner Hub Bearing	2	25	731989	CONE, Outer Hub Bearing	2
11	108705	SEAL, Hub Oil	2	26	107728	NUT, Spindle - Inner	2
12		BRAKE ASSY - See Index		27	108707	GASKET, Hub Cap	2
13	108472	BOLT, Spindle & Brake Attaching	24	28	108706	CAP, Hub	2
14	111658	WASHER, Spindle & Brake Attaching	24	29	109135	HUB ASSY (Inc. 7, 10)	2
15	107732	NUT, Spindle & Brake Attaching	24				

(Not Sold Separately)

WHEN ORDERING PARTS, ALWAYS STATE MODEL AND SERIAL NO. OF MACHINE

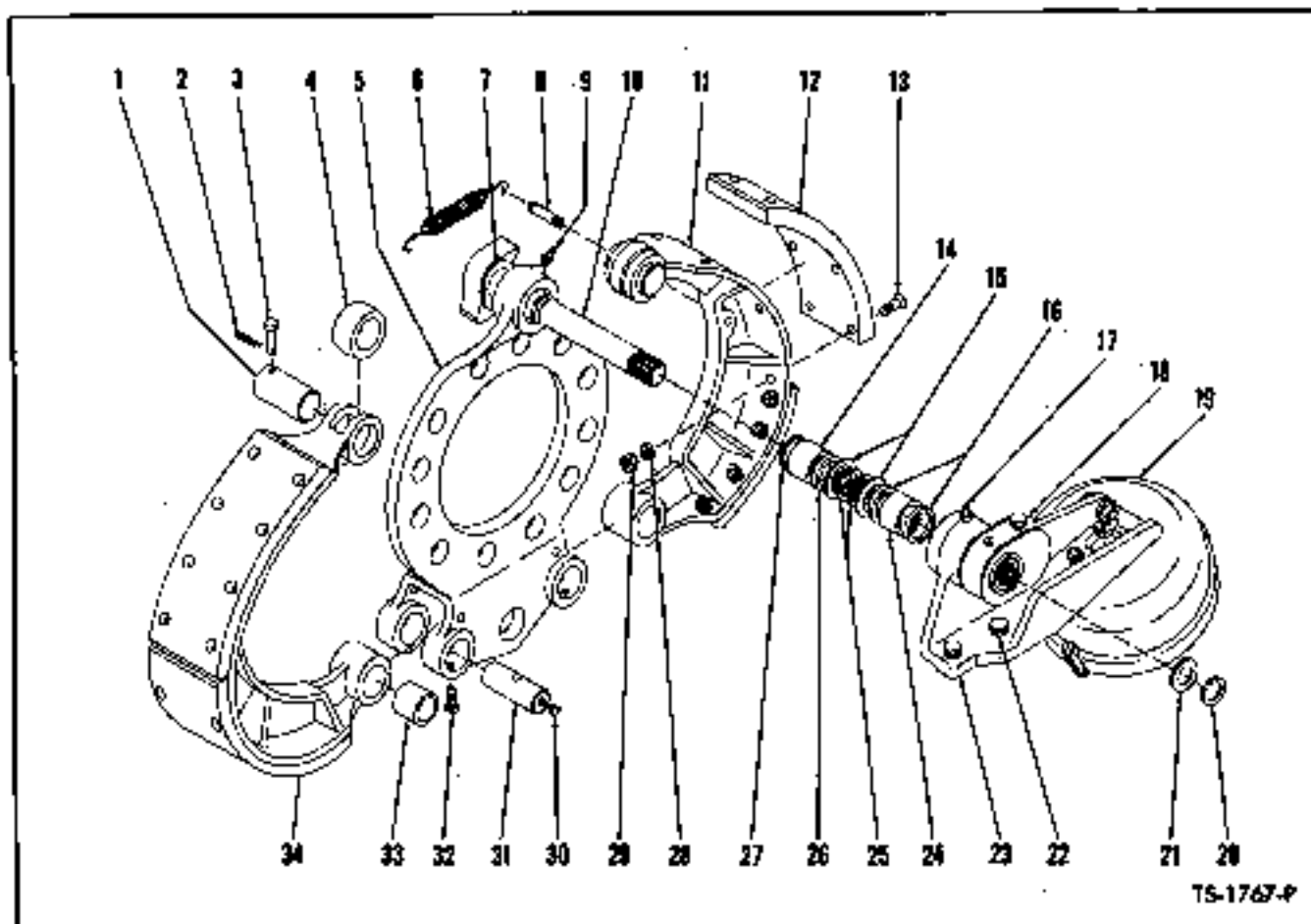

TS-1767-P

BRAKE ASSEMBLY — REAR

Item No.	Part No.	Description	No. Req'd.	Item No.	Part No.	Description	No. Req'd.
A	108456	BRAKE ASSY (Inc. 1 thru 6, B, 11, 12, 13, 28 thru 34)	2	17	12H-15	FITTING, Air Chamber Bracket Grease	1
		NOTE: 2 Brake Assemblies required per axle. Quantities listed below one for 1 Brake Assembly.		18	108476	*ADJUSTER, Brake Slack — B.W. #226555	1
1	109598	PIN, Brake Cam Roller	2	19	110206	*AIR CHAMBER — B.W. #229403	1
2	1F-308	COTTER, Roller Pin Lock Pin	2	20	224032	RING, Slack Adjuster Retaining	1
3	110855	PIN, Cam Roller Pin Lock	2	21	107010	WASHER, Slack Adjuster Retaining	1
4	107707	ROLLER, Brake Cam	2	22	1C-1236	BOLT, Air Chamber Bracket	2
5	107713	SPIDER, Brake	1	22A	4E-12	LKWSHR, Air Chamber Bracket	2
6	110814	SPRING, Brake Shoe Return	1	23	108467	BRACKET, Air Chamber — R.H.	1
7	107735	WASHER, Cam Shaft Thrust	1	23A	108468	BRACKET, Air Chamber — L.H.	1
8	110126	PIN, Spring Anchor	2	24	107739	BUSHING, Air Chamber Bracket	1
9	12H-15	FITTING, Brake Spider Grease	1	25	660516	RING, Cam Shaft Retaining	2
10	107940	CAM SHAFT — R.H.	1	26	11E-135	RETAINER, Cam Shaft Grease	1
10A	107941	CAM SHAFT — L.H.	1	27	25K-60134	"O" RING, Cam Shaft	1
11	---	SHOE, Brake — See 34	2	28	24E-06	LKWSHR, Lining to Shoe	32
12	111056	LINING, Brake Shoe	4	29	21D-06	NUT, Lining to Shoe	32
13	111305	BOLT, Lining to Shoe	32	30	16F-04	PLUG, Anchor Pin	1
14	107739	BUSHING, Brake Spider	1	31	109599	PIN, Brake Shoe Anchor	2
15	107736	WASHER, Cam Shaft Retaining	2	32	109597	SET SCREW, Anchor Pin	2
16	11E-135	RETAINER, Cam Shaft Grease	2	33	107709	BUSHING, Brake Shoe	2
				34	111053	SHOE ASSY, Brake (Inc. 1, 2, 3, 4, 8, 11, 12, 13, 28, 29, 33)	2

§Not Sold Separately

*NOTE: Your local authorized Bendix Westinghouse Distributor or Dealer is equipped to service and supply these parts.

WHEN ORDERING PARTS, ALWAYS STATE MODEL AND SERIAL NO. OF MACHINE

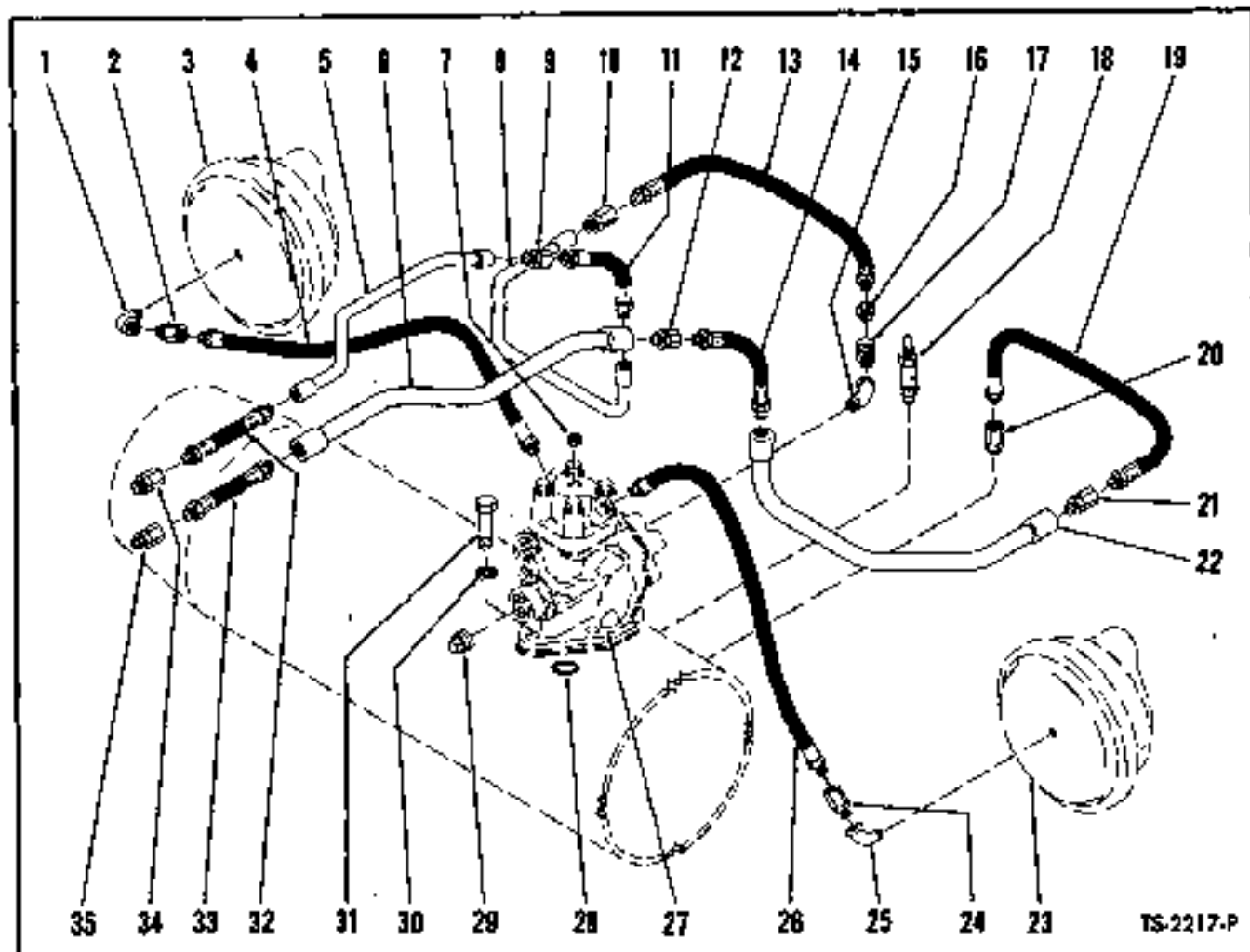

BRAKE AIR LINES - REAR DUMP

Part No.	Part No.	Description	No. Req'd.	Part No.	Part No.	Description	No. Req'd.
1	26F-2	ELBOW, Air Chamber	1	19	594438	HOSE, Pipe to Air Reservoir	1
2	36F-2	ADAPTER UNION	1	20	33F-4	ADAPTER UNION	1
3	---	AIR CHAMBER - See Index	1	21	36F-4	ADAPTER UNION	1
4	593829	HOSE, Relay Valve to Air Chamber	1	22	593963	PIPE, L.H. (On Yoke)	1
5	593959	PIPE, R.H. (On Yoke)	1	23	---	AIR CHAMBER - See Index	1
6	593958	PIPE, L.H. (On Yoke)	1	24	36F-2	ADAPTER UNION	1
7	13F-04	PLUG, Relay Valve	1	25	26F-2	ELBOW, Air Chamber	1
8	593966	PIPE, R.H. (On Yoke)	1	26	593829	HOSE, Relay Valve to Air Chamber	1
9	36F-3	ADAPTER UNION	1	27	515125	*VALVE, Relay - B.W. #254497	1
10	36F-3	ADAPTER UNION	1	28	25K-40024	"O" RING, Relay Valve	1
11	592741	HOSE, Pipe to Pipe	1	29	13F-08	PLUG, Relay Valve	1
12	36F-4	ADAPTER UNION	1	30	4E-06	WASHER, Relay Valve Attaching	3
13	594439	HOSE, Pipe to Relay Valve	1	31	2C-616	BOLT, Relay Valve Attaching	3
14	592742	HOSE, Pipe to Pipe	1	32	592741	HOSE, Pipe to Pipe	1
15	26F-2	ELBOW, Air Filter to Relay Valve	1	33	592742	HOSE, Pipe to Pipe	1
16	711186	ADAPTER UNION	1	34	36F-3	ADAPTER UNION	1
17	108573	FILTER, Air	1	35	36F-4	ADAPTER UNION	1
18	507815	*VALVE, Safety - B.W. #205105	1				

*NOTE: Your local authorized Bendix Westinghouse Distributor or Dealer is equipped to service and supply these parts.

WHEN ORDERING PARTS, ALWAYS STATE MODEL AND SERIAL NO. OF MACHINE

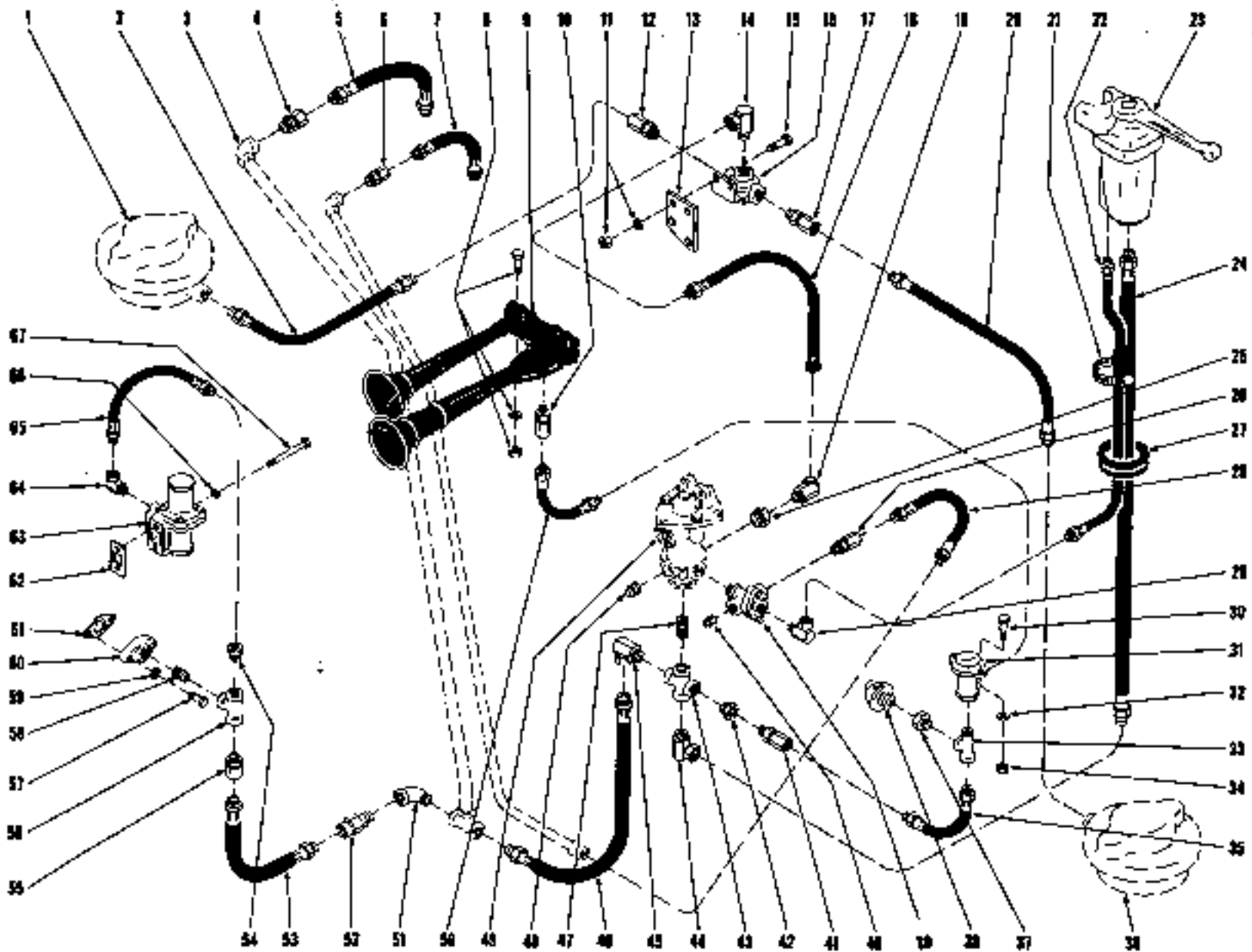

BRAKE AIR LINES - TRACTOR (FOR TRACTOR WAGON - REAR DUMP - MACHINES)

TS-2266-P

[4]

PH. 1465

BRAKE AIR LINES — TRACTOR

Item No.	Part No.	Description	No. Req'd.	Item No.	Part No.	Description	No. Req'd.
1	—	AIR CHAMBER — See Parts Manual No. 1392	1	31	530663	*VALVE, Horn — B.W. #226672	1
2	593474	HOSE, Q.R.V. to Air Chamber	1	32	4E-04	LKWSHR, Horn Valve Attaching	2
3	594143	PIPE ASSY, Firewall	1	33	17F-2	TEE, Horn Valve	1
4	36F-4	ADAPTER UNION	1	34	2D-04	NUT, Horn Valve Attaching	2
5	594132	HOSE, Firewall Pipe to Steering Assy Pipe	1	35	593438	HOSE, Cross to Horn Valve	1
6	36F-3	ADAPTER UNION	1	36	—	AIR CHAMBER — See Parts Manual No. 1392	1
7	594133	HOSE, Firewall Pipe to Steering Assy Pipe	1	37	356611	BUSHING, Tee Reducing	1
8	2C-508	BOLT, Air Horn Attaching	1	38	940643	SENDER UNIT, Air Pressure	1
8A	2D-05	NUT, Air Horn Attaching	1	39	594408	*VALVE, Double Check — B.W. #237239	1
8B	4E-05	LKWSHR, Air Horn Attaching	1	40	13F-04	PLUG, Double Check Valve	1
9	593388	*HORN, Air — B.W. #223585	1	41	36F-2	ADAPTER UNION	1
10	36F-1	ADAPTER UNION	1	42	356615	BUSHING, Cross Reducing	1
11	2D-05	NUT, Q.R.V. to Bracket	2	43	21F-4	CROSS, Foot Valve	1
11A	4E-05	LKWSHR, Q.R.V. to Bracket	2	44	301841	ADAPTER UNION	1
12	36F-2	ADAPTER UNION	1	45	31F-4	ADAPTER UNION	1
13	593478	BRACKET, Quick Release Valve	1	46	592783	HOSE, Pipe to Cross	1
14	31F-3	ADAPTER UNION	1	47	5K-409	NIPPLE, Cross to Foot Valve	1
15	2C-512	BOLT, Q.R.V. to Bracket	2	48	13F-08	PLUG, Foot Valve	2
16	507816	*VALVE, Quick Release — B.W. #205000	1	49	—	BRAKE CONTROLS — See Parts Manual No. 1392	—
17	36F-2	ADAPTER UNION	1	50	593435	HOSE, Horn Valve to Horn	1
18	594091	HOSE, Foot Valve to Q.R.V.	1	51	26F-4	ELBOW, Check Valve to Pipe	1
19	33F-3	ADAPTER UNION	1	52	593370	*VALVE, Check — B.W. #228194	1
20	593449	HOSE, Q.R.V. to Air Chamber	1	53	593280	HOSE, Compressor to Pipe	1
21	30H-45	CUP, Hose	2	54	356616	BUSHING, Tee Reducing	1
21A	1D-04	†NUT, Clip	2	55	36F-4	ADAPTER UNION	1
21B	4E-04	†LKWSHR, Clip	2	56	18F-4	TEE, Discharge Fitting	1
22	593371	HOSE, Double Check Valve to Hand Valve	1	57	1C-516	BOLT, Discharge Fitting	2
23	592291	*VALVE, Brake Hand — B.W. #224491	1	58	5K-409	NIPPLE, Tee to Discharge Fitting	1
24	593371	HOSE, Foot Valve Cross to Hand Valve	1	59	4E-05	LKWSHR, Discharge Fitting	2
25	356614	BUSHING, Foot Valve Reducing	1	60	510452	*FITTING, Discharge — B.W. #213042	1
26	711186	ADAPTER UNION	1	61	951948	*GASKET, Discharge Fitting — B.W. #204920	1
27	652402	GROMMET, Hose	1	62	942646	*GASKET, Governor — B.W. #223577	1
28	592784	HOSE, Double Check Valve to Pipe	1	63	942645	*GOVERNOR, Air Compressor — B.W. #226363	1
29	31F-2	ADAPTER UNION	1	64	31F-1	ADAPTER UNION	1
30	2C-412	BOLT, Horn Valve Attaching	2	65	593650	HOSE, Governor to Tee	1
				66	4E-05	LKWSHR, Governor to Compressor	2
				67	1C-548	BOLT, Governor to Compressor	2

*NOTE: Your local authorized Bendix Westinghouse Distributor or Dealer is equipped to service and supply these parts.
†Not Illustrated

WHEN ORDERING PARTS, ALWAYS STATE MODEL AND SERIAL NO. OF MACHINE

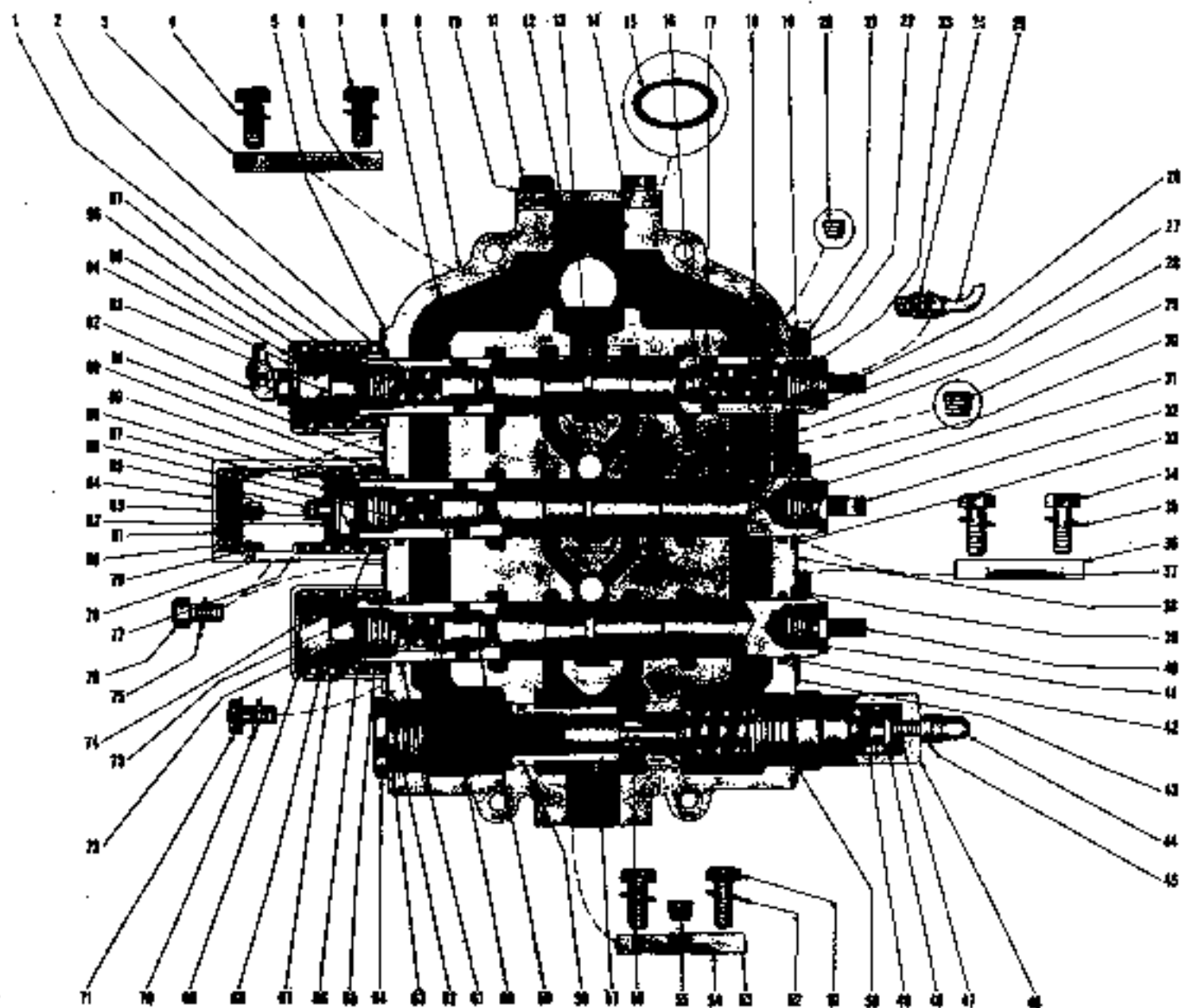

CONTROL VALVE - REAR DUMP

TS-1692-P

CONTROL VALVE - REAR DUMP

Item No.	Part No.	Description	No. Req'd.	Item No.	Part No.	Description	No. Req'd.
A	580950	VALVE ASSY (Inc. 1 thru 97)	1	50	25K-40124	"O" RING, Relief Valve Adjusting Cap	1
1	944156	RETAINER, Plunger Spring	1	51	2C-820	BOLT, Cover	2
2	940166	SPRING, Check Plunger	1	52	4E-08	LKWSHR, Cover	2
3	943197	COVER	1	53	943488	PLATE, Cylinder Port Cover	1
4	4E-08	LKWSHR, Cover Bolt	2	54	25K-40128	"O" RING, Cover Plate	1
5	944147	GASKET, Detent Cover	1	55	16F-04	PLUG, Cover Plate	1
6	25K-40208	"O" RING, Cover	1	56	943193	PLUNGER, Relief Valve	1
7	2C-820	BOLT, Cover	2	57	943192	SEAT, Relief Valve Plunger	1
8	943184	VALVE, Plunger Check	1	58	25K-40116	"O" RING, Relief Valve Plunger Seat	1
9		§HOUSING - See "A"	-	59	943184	VALVE, Plunger Check	1
10	4E-08	LKWSHR, Cover Bolt	2	60	940166	SPRING, Check Valve	1
11	2C-820	BOLT, Cover	2	61	943181	QUAD RING, Plunger	1
12	943197	COVER	1	62	943188	GASKET, Spring Cover	1
13		§SPOOLS - See "A"	-	63	25K-40124	"O" RING, Housing Cover	1
14	25K-40208	"O" RING, Cover	1	64	943190	CAP, Relief Valve Housing	1
15	25K-60204	"O" RING, Valve to Reservoir	1	65	943182	RETAINER, Plunger Spring	1
16	944144	VALVE, Plunger Check	1	66	943179	"O" RING, Plunger Cap	1
17	743593	SPACER, Check Valve Spring	1	67	943183	SPRING, Plunger Return	1
18	944143	SPRING, Check Valve	1	68	943189	COVER, Plunger Spring	1
19	4E-05	LKWSHR, Retainer Plate	6	69	943182	RETAINER, Plunger Spring	1
20	16F-02	PLUG	1	70	4E-05	LKWSHR, Spring Cover	4
21	1C-512	BOLT, Retainer Plate	6	71	1C-512	BOLT, Spring Cover	4
22	943187	WIPER, Plunger	1	72	943185	CAP, Plunger	1
23	943179	"O" RING, Plunger Eye	1	73	943184	VALVE, Plunger Check	1
24	89F-3	CONNECTOR, Oil Line Tube	1	74	943183	SPRING, Plunger Return	1
25	944146	TUBE, Oil Line	1	75	4E-05	LKWSHR, Detent Housing	8
26	943180	EYE, Plunger	1	76	11G-512	BOLT, Detent Housing	8
27	943181	QUAD RING, Plunger	1	77	944152	WASHER, Spring Stop	1
28	943186	PLATE, Wiper Retaining	1	78	944150	RING, Detent Snap	1
29	16F-08	PLUG, Clean Out	2	79	944149	SPACER, Detent Spring	1
30	943181	QUAD RING, Plunger	1	80	755762	RING, Detent Spring Retaining	1
31	943179	"O" RING, Plunger Eye	1	81	944151	POPPET, Detent	1
32	943180	EYE, Plunger	1	82	675436	PIN, Plunger Cap Roll	1
33	943187	WIPER, Plunger	1	83	944148	PIN, Plunger Cap	1
34	2C-820	BOLT, Cover	4	84	944157	HOUSING, Detent	1
35	4E-08	LKWSHR, Cover	4	85	660178	PIN, Plunger Cap Roll	1
36	943191	COVER	2	86	940166	SPRING, Check Plunger	1
37	25K-40128	"O" RING, Cover	2	87	944153	CAP, Plunger End	1
38	943186	PLATE, Wiper Retaining	1	88	943179	"O" RING, End Cap	1
39	943187	WIPER, Plunger	1	89	944154	RETAINER, Plunger Spring	1
40	943180	EYE, Plunger	1	90	943181	QUAD RING, Plunger	1
41	943179	"O" RING, Plunger Eye	1	91	944147	GASKET, Detent Cover	1
42	943181	QUAD RING, Plunger	1	92	89F-3	ELBOW, Oil Line Tube	1
43	943186	PLATE, Wiper Retaining	1	93	943185	CAP, Plunger End	1
44	863045	NUT, Relief Valve Acorn	1	94	944156	RETAINER, Plunger Spring	1
45	8D-06	NUT, Adjusting Screw Jam	1	95	944155	COVER, Plunger Spring	1
46	943196	CAP, Relief Valve Adjusting	1	96	943183	SPRING, Plunger Return	1
47	940278	SCREW, Relief Valve Adjusting	1	97	943179	"O" RING, End Cap	1
48	943195	GUIDE, Relief Valve Spring	1	98	2C-880	1BOLT, Valve to Reservoir	3
49	519251	SPRING, Relief Valve	1	99	4E-08	1LKWSHR, Valve to Reservoir	3

†Not Illustrated

‡Not Sold Separately. Order complete Valve Assembly.

WHEN ORDERING PARTS, ALWAYS STATE MODEL AND SERIAL NO. OF MACHINE

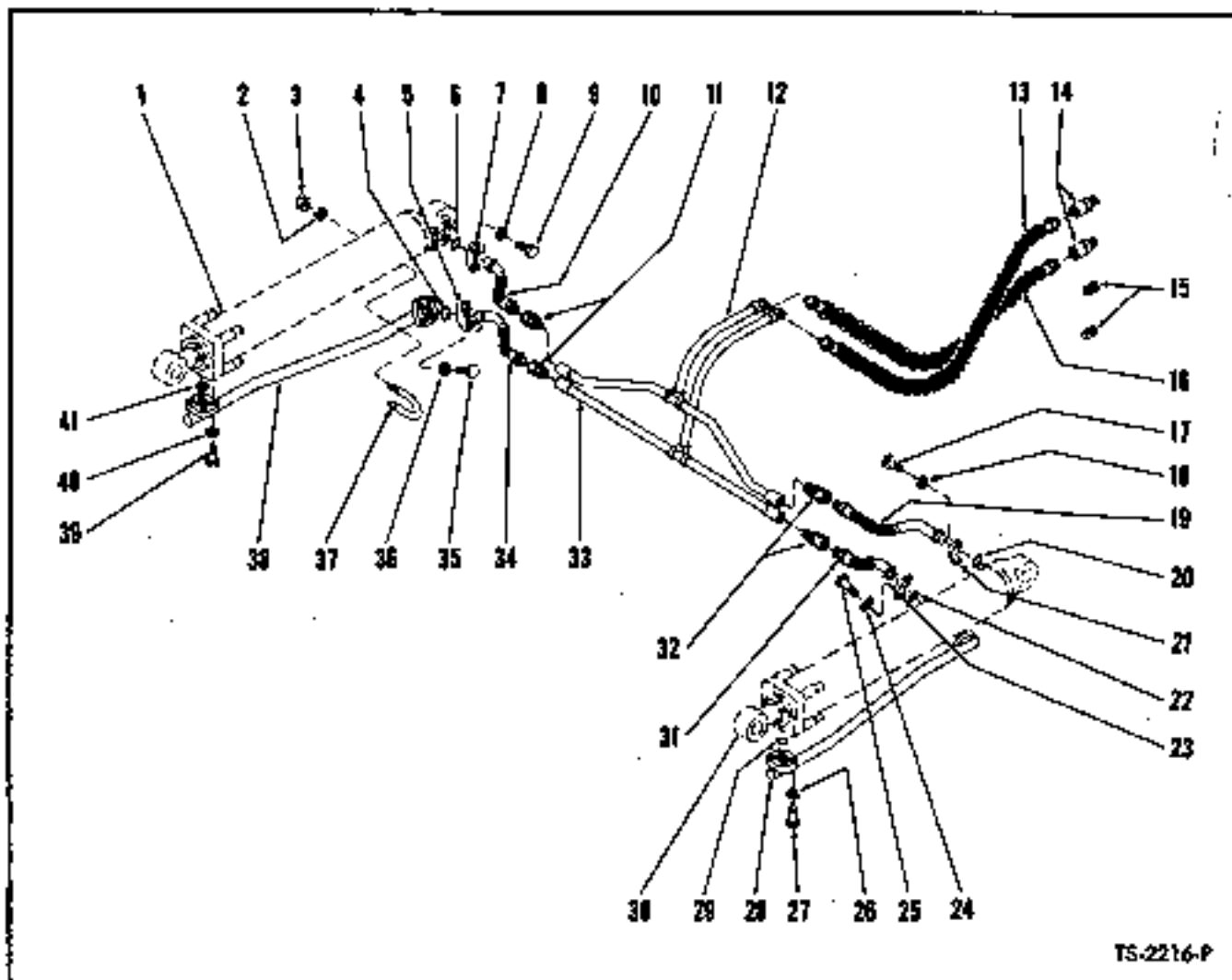

TS-2216-P

HYDRAULIC SYSTEM — DUMP

Fig. No.	Part No.	Description	No. Req'd.	Fig. No.	Part No.	Description	No. Req'd.
1		DUMP CYLINDER — See Index	—	22	25K-40110	"O" RING, Hose to Cylinder Pipe	1
2	4E-04	LKWSHR, U-Bolt	4	23	663093	FLANGE HALF, Hose to Cylinder Pipe	2
3	2D-04	NUT, U-Bolt	4	24	4E-06	LKWSHR, Flange Half to Cylinder Pipe	4
4	25K-40110	"O" RING, Hose to Pipe	1	25	1C-620	BOLT, Flange Half to Cylinder Pipe	4
5	663093	FLANGE HALF, Hose to Pipe	2	26	4E-06	LKWSHR, Cylinder Pipe to Cylinder	4
6	25K-40116	"O" RING, Hose to Cylinder	1	27	1C-620	BOLT, Cylinder Pipe to Cylinder	4
7	663094	FLANGE HALF, Hose to Cylinder	2	28	581050	PIPE, R.H. Cylinder	1
8	4E-07	LKWSHR, Flange Half to Cylinder	4	29	25K-40110	"O" RING, Pipe to Cylinder	1
9	1C-722	BOLT, Flange Half to Cylinder	4	30		DUMP CYLINDER — See Index	—
10	580846	HOSE, Pipe to Cylinder	1	31	594020	HOSE, Pipe to Cylinder Pipe	1
11	36F-6	ADAPTER UNION	2	32	36F-6	ADAPTER UNION	2
12	593954	PIPE, Left Hand	1	33	593950	PIPE, Right Hand	1
13	516599	HOSE, Strg. Assy Pipe to Rear Pipe	1	34	594020	HOSE, Pipe to Cylinder Pipe	1
14	36F-6	ADAPTER UNION	2	35	1C-620	BOLT, Flange Half to Cylinder Pipe	4
15	13F-16	PLUG, Scraper Pipes	2	36	4E-06	LKWSHR, Flange Half to Cylinder Pipe	4
16	516599	HOSE, Scraper Pipe to Rear Pipe	1	37	594355	U-BOLT, Cylinder Pipe to Cylinder	1
17	1C-722	BOLT, Flange Half to Cylinder	4	38	581049	PIPE, L.H. Cylinder	1
18	4E-07	LKWSHR, Flange Half to Cylinder	4	39	1C-620	BOLT, Cylinder Pipe to Cylinder	4
19	580846	HOSE, Pipe to Cylinder	1	40	4E-06	LKWSHR, Cylinder Pipe to Cylinder	4
20	25K-40116	"O" RING, Hose to Cylinder	1	41	25K-40110	"O" RING, Cylinder Pipe to Cylinder	1
21	663094	FLANGE HALF, Hose to Cylinder	2				

WHEN ORDERING PARTS, ALWAYS STATE MODEL AND SERIAL NO. OF MACHINE

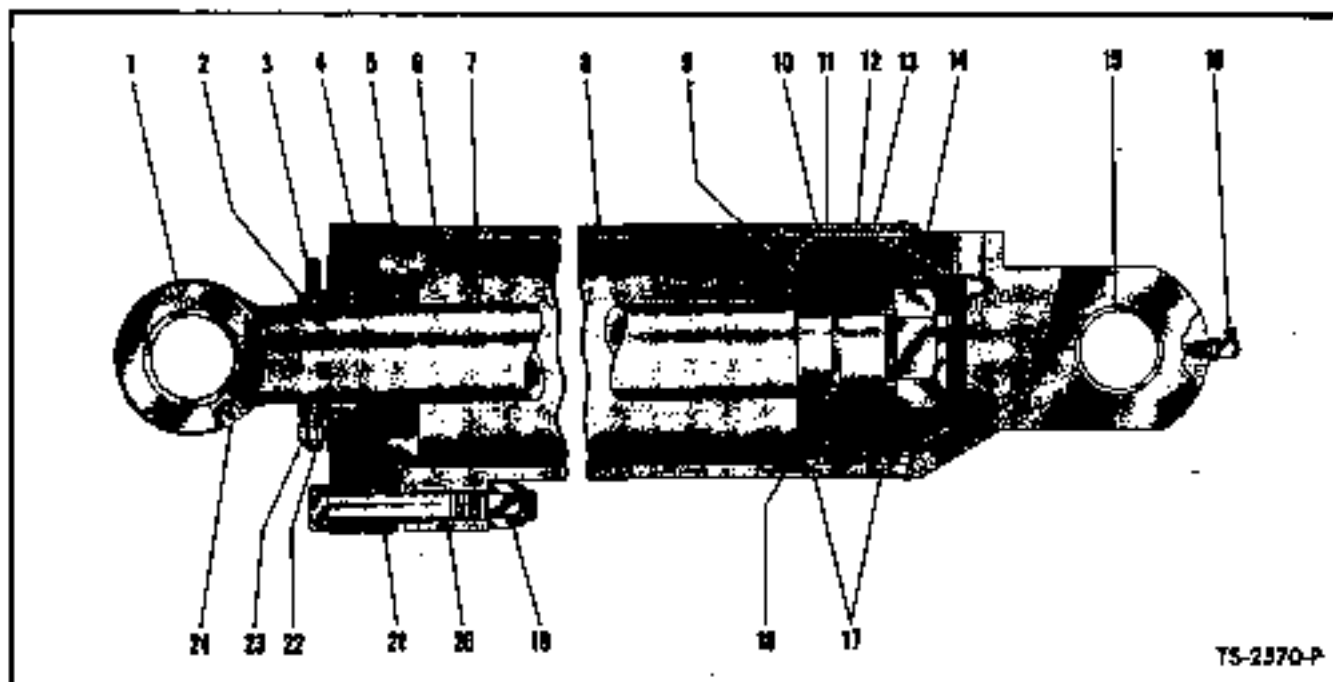

CYLINDER DUMP

Item No.	Part No.	Description	Qty. Req'd
A		*CYLINDER ASSY (Inc. 1 thru 24)	
B	580794	Right Hand	1
C	580789	Left Hand	1
*NOTE: 2 Cylinders used on machines - Quantities listed below are for 1 Cylinder.			
1	512726	BUSHING, Piston Rod	1
2	941569	WIPER, Piston Rod	1
3	512747	RETAINER, Piston Rod Wiper	1
4	532272	PACKING SET, Cylinder Cap	1
5	25K-40800	"O" RING, Cylinder Cap	1
6	514740	ADAPTER, Male Chevron Packing	2
7	536382	ROD ASSY, Piston (Inc. 1)	1
8		CYLINDER TUBE (Inc. 15)	
8A	580795	Right Hand	1
8B	580790	Left Hand	1
9	528180	PISTON <i>2 - 541582 SUPERSEDES 528180</i>	1 - Pg. 2004
10	514755	SHIM, Piston Packing	2
11	514753	ADAPTER, Female Chevron Packing	2
12	509956 <i>580237</i>	PACKING SET, Piston	1
13	514752	ADAPTER, Male Chevron Packing	2
14	536058	NUT, Piston Rod	1
15	512726	BUSHING, Cylinder Tube	1
16	12H-15	FITTING, Cylinder Grease	1
17	524057	RING, Piston Wear	2
18	25K-40216	"O" RING, Piston Rod	1
19	580-16 <i>180-16</i>	NUT, Cylinder Cap	4
20	24C-16128	BOLT, Cylinder Cap	4
21	581957	**CAP, Cylinder	1
22	528103	GLAND, Packing	1
23	4C-820	BOLT, Packing Gland	4
24	10H-25	FITTING, Piston Rod Grease	1

**NOTE: 581957 Cap can be used only with 528180 Piston (illustrated as item 9). Machines with old style cap must install 528180 Piston when installing 581957 Cap.
[As Required]

WHEN ORDERING PARTS, ALWAYS STATE MODEL AND SERIAL NO. OF MACHINE

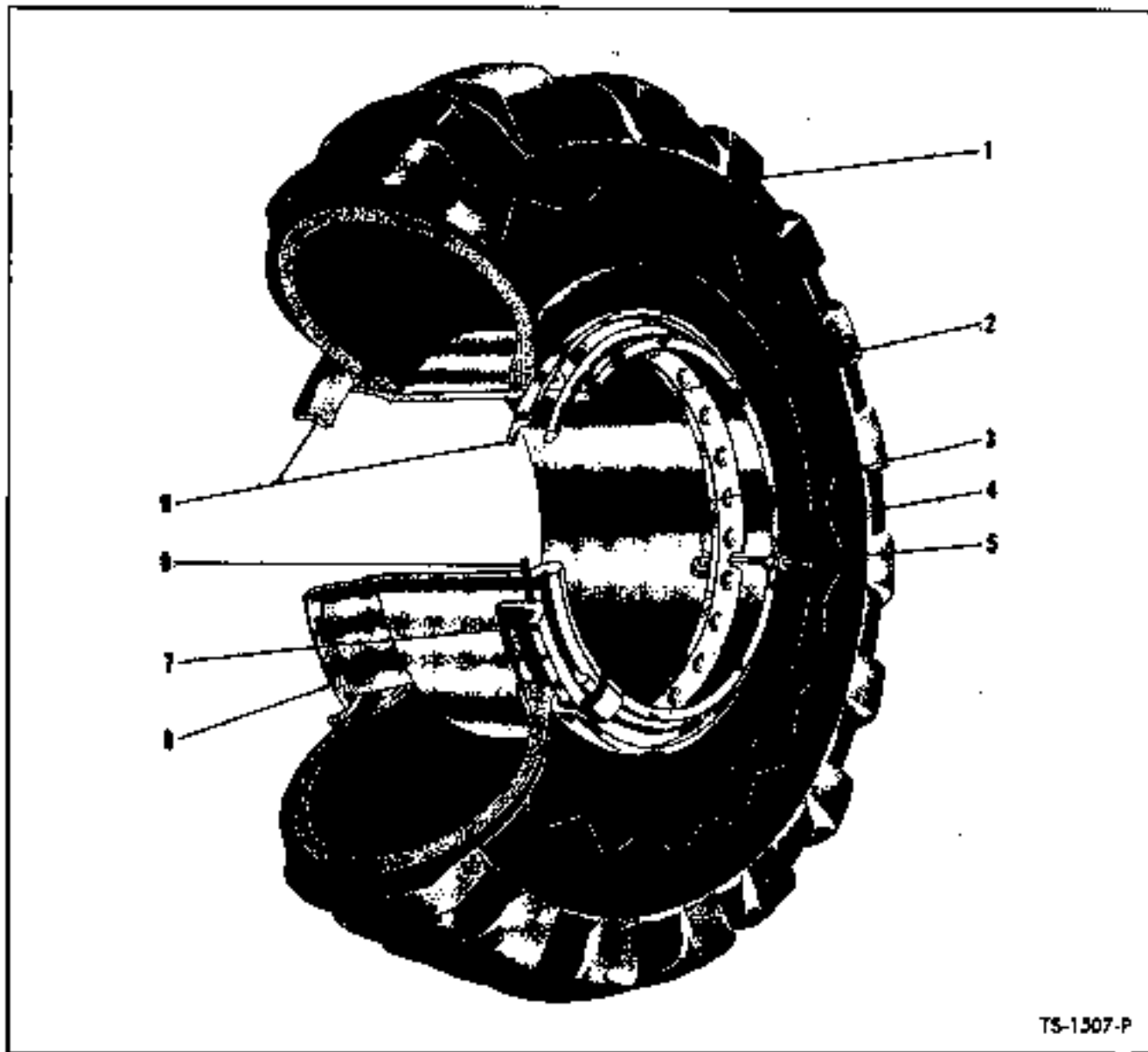

TS-1507-P

WHEEL AND TIRE DATA

Item No	24.5 x 29	29.5 x 33	DESCRIPTION	No. Req'd.
1	-----	-----	TIRE	2
2	523253	580274	RING, Lock	2
3	529107	509445	VALVE STEM	2
4	551684	-----	ADAPTER, Valve Stem	2
5	551683	-----	CAP, Valve	2
6	582124	581649	WHEEL	2
7	523252	580278 ⁶¹²⁴⁰⁵	BAND, Bead Seat	2
8	513117	580278	"O" RING	2
9	580479	522329	FLANGE	4

*NOTE: 529370 PLUG must be used with each 581649 Wheel.

WHEN ORDERING PARTS, ALWAYS STATE MODEL AND SERIAL NO. OF MACHINE

DECALS

Item No.	Part No.	Description	Qty. Req'd
1	944293	DECAL KIT (incl. 2 Wrenches)	1
2	551741	DECAL, Clark Equipment	2
3	593211	DECAL, Model	2
4	502776	DECAL, Michigan	2
5	528694	DECAL, Patent	1

542074 - Plate, Patent plus (4) 60-605 Screw replaces
528694 Patent Decal. Scrap stock of 528694 Decal.

Item No.	Part No.	Description	Qty. Req'd
6	553412	WRENCH, Wheel	1
7	552164	HANDLE, Wheel Wrench	1
8	522996	WRENCH, Hub Bearing - 3 1/4"	1
9	522997	WRENCH, Hub Bearing - 5 1/4"	1
10	523029	SLEEVE, Piston Rod Wiper Taper	1
11	515201	RING, Packing Compressor	1

TRANSMISSION AND DRIVE SHAFT ROCK GUARD

Item No.	Part No.	Description	Qty. Req'd
1	560869	ROCK GUARD, Transmission	1
2	2C-820	BOLT, Guard Attaching	2
3	2D-08	NUT, Guard Attaching	2
4	4E-08	LKWSHR, Guard Attaching	2
5	560872	ROCK GUARD, Drive Shaft - L.H.	1
6	560873	ROCK GUARD, Drive Shaft - R.H.	1
7	2C-816	BOLT, L.H. Guard to R.H. Guard	2
8	2D-08	NUT, L.H. Guard to R.H. Guard	2
9	4E-08	LKWSHR, L.H. Guard to R.H. Guard	2
10	2C-624	BOLT, Guards to Frame	4
11	2D-06	NUT, Guards to Frame	4
12	4E-06	LKWSHR, Guards to Frame	4

WHEN ORDERING PARTS, ALWAYS STATE MODEL AND SERIAL NO. OF MACHINE

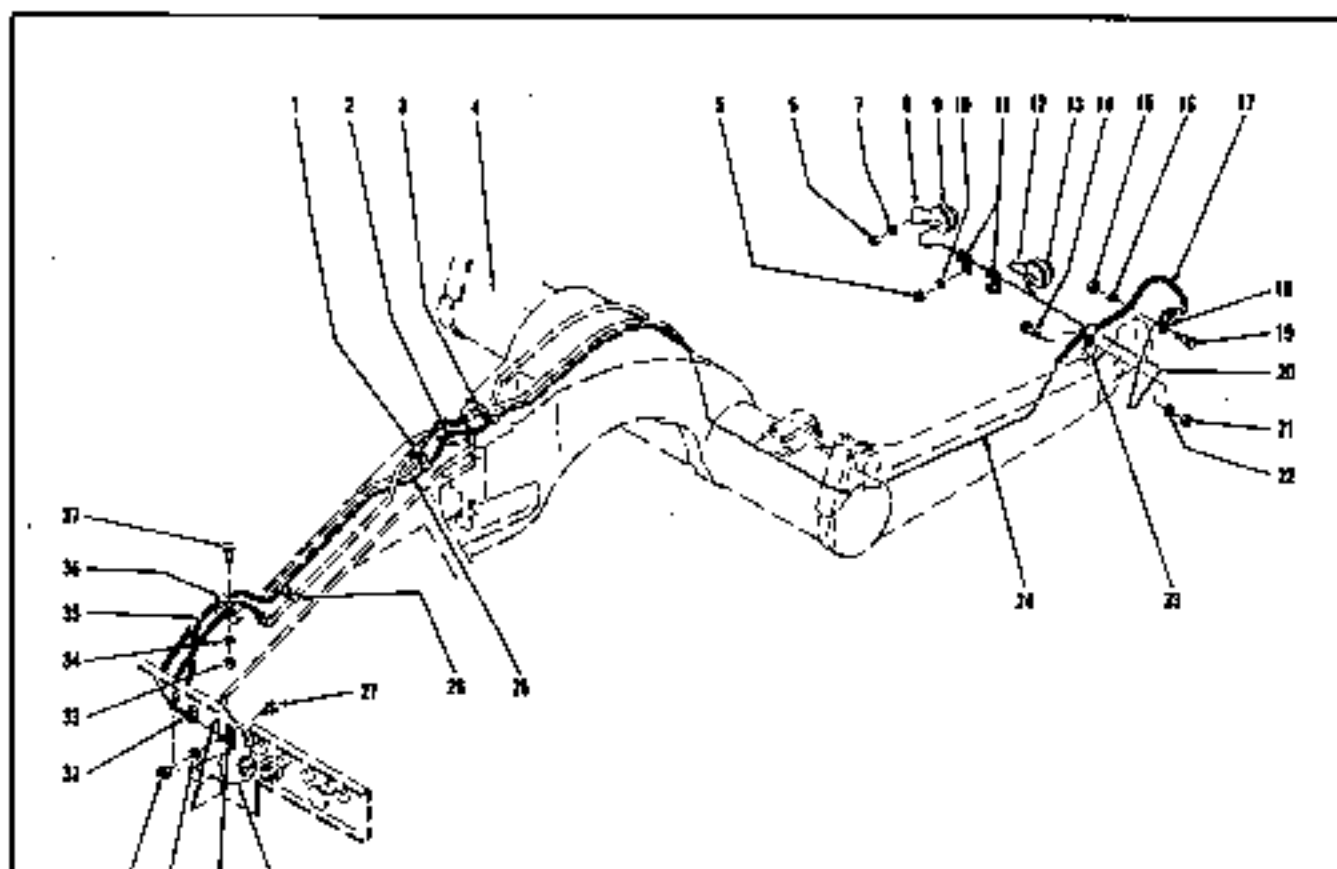

*NOTE: 945960 Lamp Kit consists of 1 - 547416 Lamp Assy,
3 #12E-10 Lkwsr, 3 #12D-10 Nut and 1 - 002128
Template Form. The serviceable items of 547416 Lamp
Assy are 551245 Sealed Beam Unit and 944976 Frame and
Retainer Assy.

TS-2626-F

Item No.	Part No.	Description	Qty. Req'd.	Item No.	Part No.	Description	Qty. Req'd.
1	580976	CLAMP, Wire Assy - Double	2	16	4E-04	LKWSHR, Clamp Attaching	1
1A	2C-410	†BOLT, Clamp Attaching	1	17	580991	WIRE ASSY	1
1B	2D-04	†NUT, Clamp Attaching	1	18	30H-45	CLAMP, Wire	1
1C	4E-04	†LKWSHR, Clamp Attaching	1	19	2C-408	BOLT, Clamp Attaching	1
2	580984	WIRE ASSY	1	20	580994	WIRE	1
3	580976	CLAMP, Wire Assy - Double	2	21	2D-04	NUT, Clamp Attaching	1
3A	2C-410	†BOLT, Clamp Attaching	1	22	4E-04	LKWSHR, Clamp Attaching	1
3B	2D-04	†NUT, Clamp Attaching	1	23	580976	CLAMP, Wire Assy - Double	2
3C	4E-04	†LKWSHR, Clamp Attaching	1	24	580970	WIRE	1
4		YOKE - See Index		25	580999	WIRE	1
5	1D-04	NUT, Clamp Attaching	2	26	580975	CLAMP, Wire Assy - Double	2
6	12D-8	NUT, Lamp Attaching	6	27	2C-408	BOLT, Clamp Attaching	1
7	13E-8	LKWSHR, Lamp Attaching	6	28	581000	WIRE	1
8	550745	WIRE, Ground	1	29	30H-7	CLAMP, Wire	1
9	551282	LAMP ASSY (Inc. 9A) 945960	1	30	4E-04	LKWSHR, Clamp Attaching	1
9A	551245	†SEALED UNIT, Lamp	1	31	2D-04	NUT, Clamp Attaching	1
10	4E-04	LKWSHR, Clamp Attaching	2	32	30H-45	CLAMP, Wire Assy	1
11	30H-7	CLAMP, Wire	2	33	2D-04	NUT, Clamp Attaching	2
12	550745	WIRE, Ground	1	34	4E-04	LKWSHR, Clamp Attaching	2
13	551282	LAMP ASSY (Inc. 13A) 945960	1	35	581001	WIRE ASSY	1
13A	551245	†SEALED UNIT, Lamp	1	36	580975	CLAMP, Wire Assy	4
14	2C-410	BOLT, Clamp Attaching	1	37	2C-410	BOLT, Clamp Attaching	2
15	2D-04	NUT, Clamp Attaching	1				

†Not Illustrated

WHEN ORDERING PARTS, ALWAYS STATE MODEL AND SERIAL NO. OF MACHINE

NUMERICAL INDEX

Part No.	Page No.	Part No.	Page No.	Part No.	Page No.	Part No.	Page No.
1C-512	9	33F-3	7	522829	12	593917	1
1C-516	7	33F-4	5	522996	13	593950	10
1C-548	7	36F-1	7	522997	10	593954	10
1C-620	10	36F-2	5, 7	523029	13	593958	5
1C-630	3	36F-3	5, 7	523252	12	593959	5
1C-718	3	36F-4	5, 7	523253	12	593963	5
1C-722	10	36F-6	10	524057	11	593966	5
1C-1236	4	62D-16	2	528103	11	594019	1
1D-04	7, 14	62D-16 <i>18D-16</i>	11	529180	11	594020	10
1F-308	4	63F-3	9	528694	13	594091	7
1F-1040	1	89F-3	9	429107	12	594132	7
2C-408	14	102429	3	530863	7	594133	7
2C-410	14	102766	3	532772	11	594143	7
2C-412	7	107010	4	534058	11	594353	10
2C-508	7	107707	4	534382	11	594390	2
2C-512	7	107709	4	550745	14	594408	7
2C-616	1, 5	107713	4	551245	14	594438	5
2C-624	13	107728	3	551282	14	594439	5
2C-816	2, 13	107729	3	551684	12	619027	2
2C-820	0, 13	107730	3	551685	12	652402	7
2C-880	9	107732	3	551741	13	653673	3
2C-10112	1, 2	107735	4	552164	13	660170	9
2D-04	7, 10, 14	107736	4	553412	13	660516	4
2D-05	7	107739	4	580273	12	663093	10
2D-06	2, 13	107940	4	580274	12	663094	10
2D-08	13	107941	4	580278	12	675434	9
2D-10	1, 2	107983	3	580477	12	711186	5, 7
4C-820	11	107985	3	580479	12	731989	3
4E-04	7, 10, 14	108456	4	580789	11	742262	3
4E-05	7, 9	108464	4	580790	11	742283	3
4E-06	1, 2, 3, 5, 10, 13	108467	4	580794	11	743593	9
4E-07	3, 10	108468	4	580795	11	755762	9
4E-08	2, 9, 13	108472	3	580797	2	863045	9
4E-10	1, 2	108476	4	580799	2	940166	9
4E-12	4	108477	3	580846	10	940778	9
5K-409	7	108498	3	580869	13	940643	7
8D-06	9	108573	5	580872	13	941569	11
10H-25	2, 11	108705	3	580873	13	942645	7
11E-135	4	108706	3	580887	2	942646	7
11G-512	9	108707	3	580920	14	943179	9
12D-8	14	109135	3	580930	9	943180	9
12H-15	4, 11	109137	3	580975	14	943181	9
13E-8	14	109597	4	580976	14	943182	9
13F-04	5, 7	109598	4	580984	14	943183	9
13F-08	5, 7	109599	4	580991	14	943184	9
13F-16	10	110126	4	580994	14	943185	9
14C-6136	2	110208	4	580999	14	943186	9
16F-02	9	110814	4	581000	14	943187	9
16F-04	4, 9	110835	4	581001	14	943188	9
16F-08	9	111053	4	581049	10	943189	9
17F-2	7	111056	4	581050	10	943190	9
18F-4	7	111905	4	581957	11	943191	9
21D-06	4	111461	3	582066	1	943192	9
21F-4	7	224032	4	590708	2	943193	9
24C-16128	11	301841	7	591623	3	943195	9
24C-18136	2	356617	7	592291	7	943196	9
24E-06	4	356614	7	592741	5	943197	9
23F-2	5	356615	7	592742	5	943488	9
25K-40024	5	356616	7	592783	7	943593	9
25K-40110	10	502776	13	592784	7	944144	9
25K-40116	9, 10	507815	5	592785	7	944145	9
25K-40124	9	507816	7	592211	13	944146	9
25K-40128	9	509356	11	593280	7	944147	9
25K-40208	9	509445	12	593370	7	944148	9
25K-40216	11	510432	7	593371	7	944149	9
25K-40800	11	512726	11	593388	7	944150	9
25K-60124	4	512747	11	593435	7	944151	9
25K-60204	9	513117	12	593436	7	944152	9
26F-2	5	514740	11	593449	7	944153	9
26F-4	7	514752	11	593474	7	944154	9
30H-7	14	514753	11	593476	7	944155	9
30H-45	7, 14	514755	11	593618	12	944156	9
31F-1	7	515125	5	593650	7	944157	9
31F-2	7	515201	13	593737	1	944273	13
31F-3	7	516599	10	593829	3	944671	1
31F-4	7	519231	9	593908	2	951948	7

NOTES