Instructions for Assembling

Special Attachments

For

Farmall-A and B Tractors

See page 2 for Index to Attachments

With "exploded" views and parts list.

**Important:
TO OWNERS—**

This pamphlet has been prepared and is furnished for the purpose of giving the user as much information as possible pertaining to the care and assembly of these attachments. The owner is urged to read and study this pamphlet and, if ordinary care is exercised, he will be assured of satisfactory service.

INTERNATIONAL HARVESTER COMPANY

(INCORPORATED)

180 NORTH MICHIGAN AVE. CHICAGO, ILLINOIS, U.S.A.

INDEX TO ATTACHMENTS

Description	Tractor Used on	Attachment No.	Page No.
Adjustable front axle.	A	48290 DA	18, 19
Adjustable front wheel	A & B	57098 D	20
Adjustable front wheel	B	57097 D	21, 22
Belt pulley.	A & B	56062 D	26
Belt pulley and power take-off	A & B	48104 DA	27 to 30
Double front wheel	B	55460 D	23, 24
Double groove fan and generator pulley hub.	A & B	28318 DX	35
Exhaust muffler.	A & B	48831 D	3
Fan with double pulley hub	A & B	28821 DA	35
Field change package	A	54141 D	10
Flywheel ring gear	A & B	56618 D	34
Front wheel weight - first	A	48600 D	7
Front wheel weight - second.	A	48602 D	7
Grossing front wheels.	A & B	23
Heavy rear wheel	B	58106 DA	12
Optional rear wheel pneumatic equipment.	A & B	11
Pneumatic tire pumps	A & B	{ 39604 D 39622 D	17
Power take-off and belt pulley	A & B	48104 DA	27 to 30
Power take-off	A & B	48153 DA	31, 32
Radiator shutter	A & B	51419 D	14 to 16
Rear wheel weight - first.	A	54142 D	9
Rear wheel weight - second	A	54143 D	9
Rear wheel weight - first.	A & B	50476 D	8
Rear wheel weight - second	A & B	50477 D	8
Rear wheel weight - first.	B	57152 D	11
Rear wheel weight - second	B	57153 D	11
Spark arrester	A & B	55348 D	4
Swinging drawbar	A	43919 DA	6
Swinging drawbar	B	52989 DA	6
5000 ft. Altitude piston (Kerosene or distillate)	A & B	53077 D	13
5000 ft. altitude piston (Gasoline).	A & B	51189 D	13
8000 ft. altitude piston (Kerosene or distillate)	A & B	53078 D	13
8000 ft. altitude piston (Gasoline).	A & B	51188 D	13

FIELD CHANGE PACKAGE (54141 D) REAR WHEEL RIGHT HAND AND REAR AXLE SHAFT

(FOR FARMALL-A TRACTORS WITH RIGHT
HAND REAR STEEL DISC WHEEL)

INSTALLATION - (See Illustration No. 15.)

Jack up the rear end of tractor as shown in regular Instruction Manual.

Remove six capscrews "A" and remove wheel rim and tire complete.

Remove four capscrews "B", cover "D", bolt "E" and pan "C".

Drive out shaft "F", using a rod approximately 1" in diameter. Be sure the rod is kept against the shaft so that the parts in rear axle housing will be kept in line.

Remove bearing from shaft and assemble on new shaft.

Reassemble the new shaft, capscrews "B" must be inserted before driving shaft in position. Reassemble capscrews "E", cover "D" and pan "C".

Assemble new wheel on rim with tire, using four new bolts at "G", then assemble wheel complete on the axle shaft, using six new capscrews at "A".

NOTE: See regular Instruction Manual for detail list of standard repair parts.

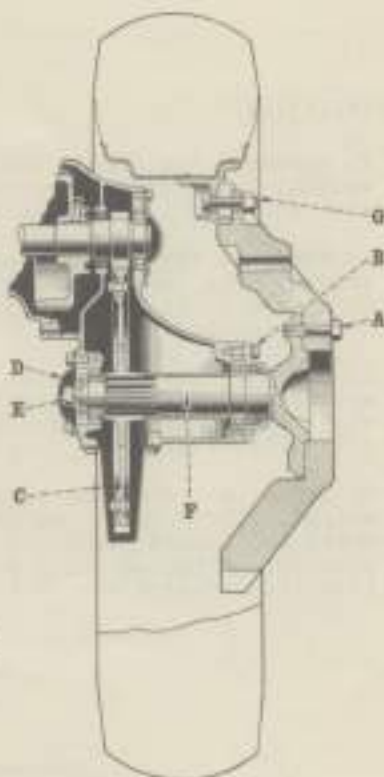

Illustration No. 15

View Showing Rear Wheel,
R.H. Assembled.

I H C Part No.	Description
8529 D	Rear wheel, right hand.
.....	Capscrew, 9/16" N.F. x 2-1/2".
.....	Square head bolt, 5/8" x 2-1/2" (for rim).
.....	Lockwasher, 9/16".
54126 D	Rear axle shaft, right hand.
.....	Capscrew, 5/8" N.F. x 1-1/4".
.....	Lockwasher, 5/8".

REAR WHEEL WEIGHT ATTACHMENTS
(FIRST-54142D)
(SECOND-54143D)

(FOR FARMALL-A TRACTORS WITH HEAVY RIGHT
 HAND REAR WHEEL-8529 D)

INSTALLATION

To assemble the first rear wheel weight, L.H., fasten weight to wheel with four $5/8 \times 3-1/2"$ bolts.

To assemble the second rear wheel weight, L.H., remove two $5/8 \times 3-1/2"$ bolts and insert two $5/8 \times 6-3/4"$ bolts provided.

To assemble the first rear wheel weight, R.H., fasten weight to wheel with four $5/8 \times 5-3/4"$ bolts.
 (See Illustration No. 14.)

To assemble the second rear wheel weight, R.H., remove two $5/8 \times 6-3/4"$ bolts and insert two $5/8 \times 9"$ bolts provided. Tighten bolts securely.
 (See Illustration No. 13.)

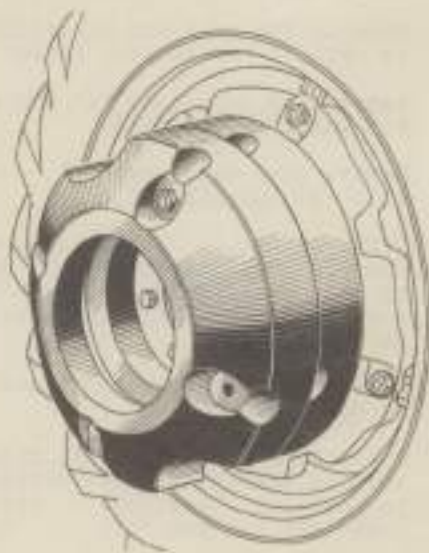

Illustration No. 13

View Showing First and Second
 Rear Wheel Weights Assembled
 - Right Hand

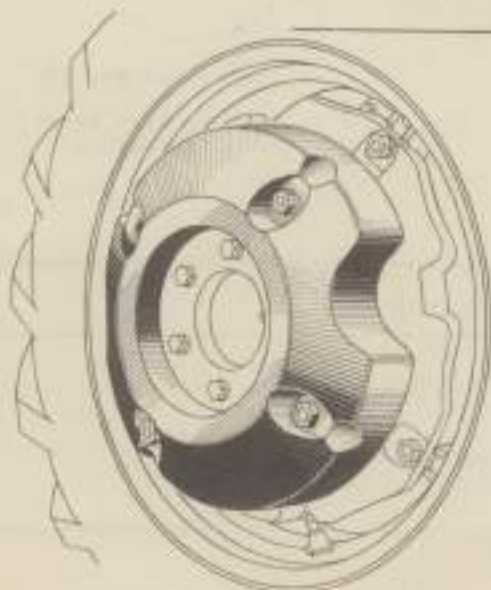

Illustration No. 14.

Unnumbered parts in the illustrations are the same as corresponding parts shown with numbers

I H C Part No.	Description
6701 DA	Rear wheel weight - first.
6701 DA	Rear wheel weight - second.

When ordering, always use I H C Part Nos.

Don't order parts from the illustrations only; refer to the list also.

REAR WHEEL WEIGHT ATTACHMENTS
(FIRST-50476D)
(SECOND-50477D)

(FOR ALL FARMALL-B TRACTORS)
 (FOR FARMALL-A TRACTORS EQUIPPED WITH RIGHT
 HAND REAR STEEL DISC WHEEL)

INSTALLATION

To assemble the first rear wheel weight, fasten weight to wheel with four $5/8 \times 3-1/2$ " bolts as shown in Illustration No. 12.

To assemble the second rear wheel weight, remove two $5/8 \times 3-1/2$ " bolts and insert two $5/8 \times 6-3/4$ " bolts provided. Tighten bolts securely. (See Illustration No. 11).

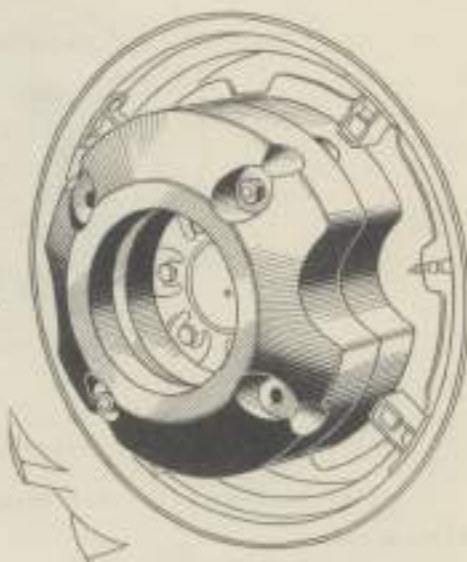

Illustration No. 11

View Showing First and Second Rear
 Wheel Weights Assembled.

Unnumbered parts in the illustrations are the same as corresponding parts shown with numbers.

I H C Part No.	Description
6701 DA	Rear wheel weight - first.
6701 DA	Rear wheel weight - second.

When ordering, always use I H C Part Nos.

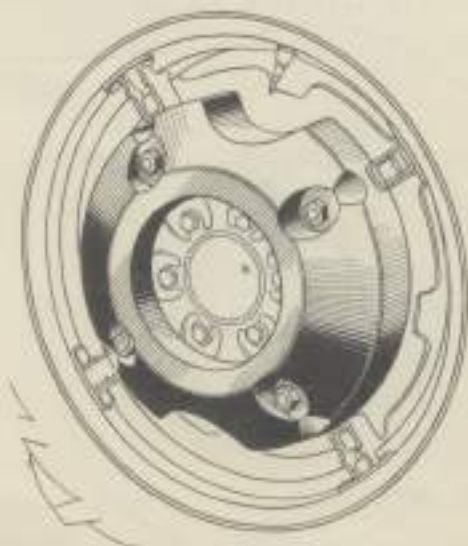

Illustration No. 12.

FRONT WHEEL WEIGHT ATTACHMENTS (FIRST-48600D) (SECOND-48602D)

(FOR FARMALL-A TRACTORS
AND
FARMALL-B WITH DOUBLE FRONT WHEELS.)

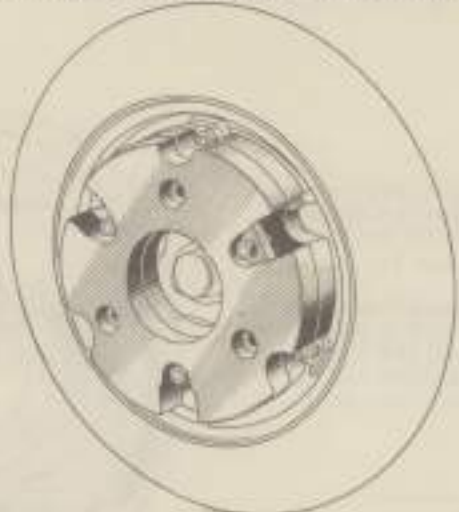

Illustration No. 8

View Showing First and Second Front Wheel Weights Assembled.

INSTALLATION

To assemble the first front wheel weight, fasten weight to wheel with three 1/2 x 2" bolts, as shown in *Illustration No. 10*.

To assemble the second front wheel weight, remove the three 1/2 x 2" bolts and insert three 1/2 x 3" bolts provided. Tighten bolts securely. (See *Illustration No. 9*).

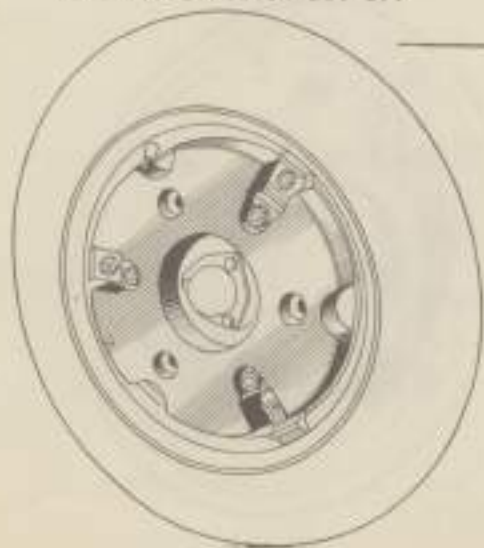

Illustration No. 10

Unnumbered parts in the illustrations are the same as corresponding parts shown with numbers.

I H C Part No.	Description
6788 D	Front wheel weight - first.
6788 D	Front wheel weight - second.

When ordering, always use I H C Part Nos.

SWINGING DRAWBAR ATTACHMENT (S2989 DA)

(FOR FARMALL-B TRACTOR ONLY)

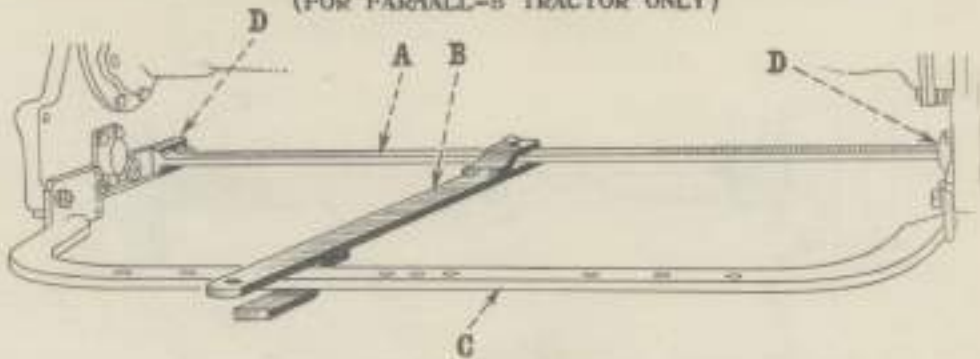

Illustration No. 7

View Showing Swinging Drawbar Attachment Assembled on Tractor.

INSTALLATION - See Illustration No. 7.

Attach drawbar anchor bar "A" to rear axle-housings and assemble swinging drawbar "B" on old drawbar "C".

CAUTION: - Before attaching anchor bar "A", be sure washers are in place at "D" to be used as shims between the rear axle housing and anchor bar.

Unnumbered parts in the illustrations are the same as corresponding parts shown with numbers.

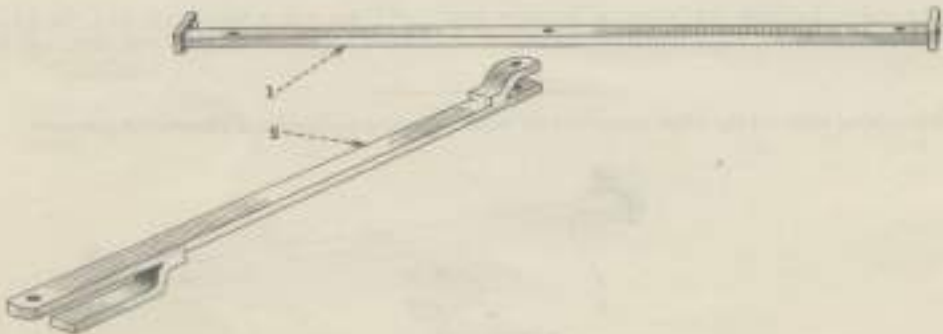

Illustration No. 8

When ordering, always use I H C Part Nos.

Ref. No.	I H C Part No.	Description
1	55245 DX	Swinging drawbar anchor bar, complete.
...	Capscrew, 5/8" N.F. x 3".
...	Hex. nut, 5/8" N.F.
...	Lockwasher, 5/8".
...	Washer, 21/32" I.D. x 1-1/4" O.D.
2	55242 DX	Swinging drawbar, complete.
...	Capscrew, 5/8" N.F. x 3".
...	Square head bolt, 3/4" x 1-1/2".
...	Hex. nut, 5/8" N.F.
...	Square nut, 3/4" N.C.
...	Lockwasher, 5/8".
...	Lockwasher, 3/4".

Don't order parts from the illustrations only; refer to the list also.

SWINGING DRAWBAR ATTACHMENT (43919DA)

(FOR FARMALL-A TRACTOR ONLY)

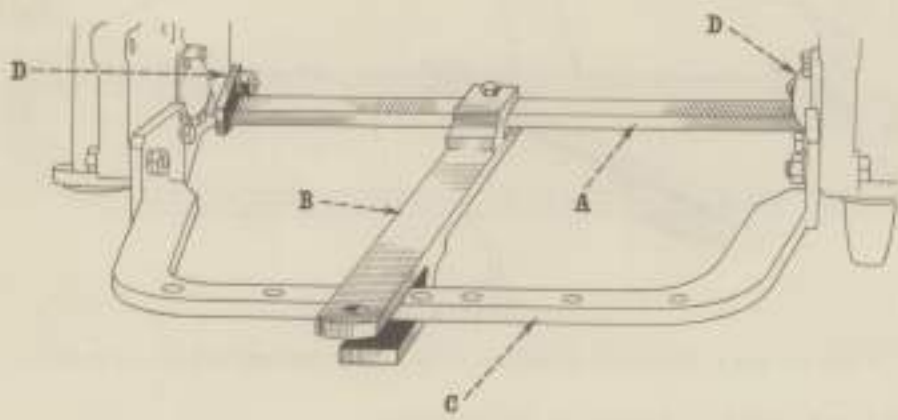

Illustration No. 5

View Showing Swinging Drawbar Attachment Assembled on Tractor.

INSTALLATION - See Illustration No. 5.

Attach drawbar anchor bar "A" to rear axle housings and assemble swinging drawbar "B" on old drawbar "C".

CAUTION:- Before attaching anchor bar "A", be sure washers are in place at "D" to be used as shims between the rear axle housing and anchor bar.

Unnumbered parts in the illustrations are the same as corresponding parts shown with numbers



Illustration No. 6

When ordering, always use I H C Part Nos.

Ref. No.	I H C Part No.	Description
1	55246 DX	Swinging drawbar anchor bar, complete.
2	55242 DX	Swinging drawbar, complete.

Don't order parts from the illustrations, refer to the list also.

SPARK ARRESTER ATTACHMENT (56348 D)

(FOR FARMALL-A AND B TRACTORS)

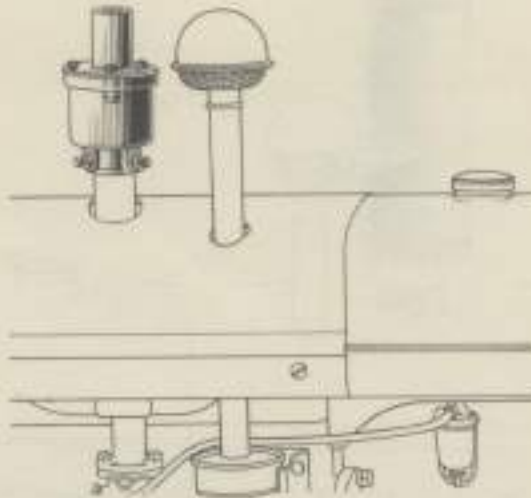

Illustration No. 3

View Showing Spark Arrester Assembled

TO ASSEMBLE

Assemble spark arrester over exhaust pipe, clamping with two set screws as shown. Clean once a month.

Ref. No.	I H C Part No.	Description
1	6616 D	Spark arrester top.
...	Square head bolt, 5/16" x 1".
...	Hex. nut, 5/16" N.C.
...	Lockwasher, 5/16".
2	5125 D	Spark arrester body.
...	Square head oval point set screw, 3/8" N.C. x 7/8".
...	Hex. jam nut, 3/8" N.C.
...	Plug, 1/2".



Illustration No. 4

Don't order parts from the illustrations only; refer to the list also.

When ordering, always use I H C Part Nos.

EXHAUST MUFFLER ATTACHMENT (48831D)

(FOR FARMALL-A AND B TRACTORS)

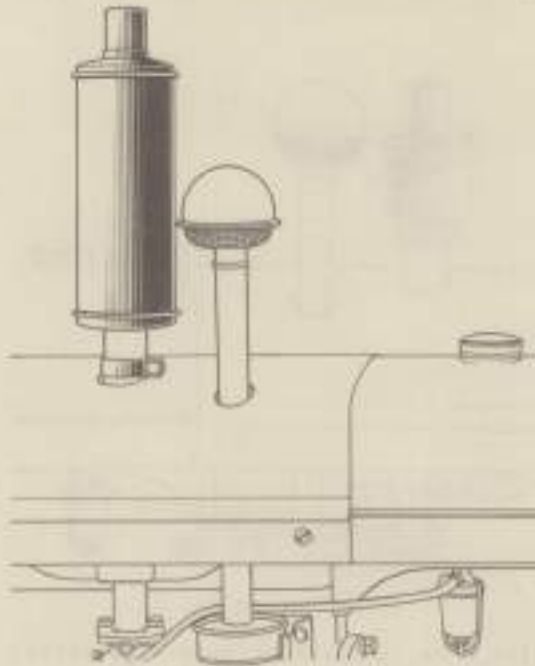

(Illustration No. 1)

View Showing Exhaust Muffler Attachment Assembled on Tractor.

INSTALLATION

Assemble exhaust muffler with the slotted end over exhaust pipe and secure with clamp provided.

When ordering, always use I H C Part Nos.

Ref. No.	I H C Part No.	Description
1	48831 D	Muffler.
2	48889 D	Clamp.
...	Square head bolt, 5/16" N.C. x 1-1/4".
...	Hex. nut, 5/16" N.C.
...	Lockwasher, 5/16".

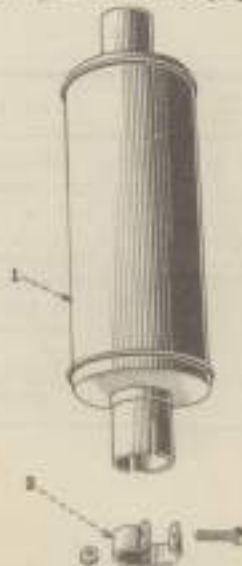

Illustration No. 2

Don't order parts from the illustrations only; refer to the list also.

REAR WHEEL WEIGHT ATTACHMENT (FIRST - 57152 D) (SECOND - 57153 D)

(FOR FARMALL-B TRACTORS WITH HEAVY REAR WHEELS (8529 D))

INSTALLATION

To assemble the first rear wheel weight, fasten weight to wheel with four 5/8" x 5-3/4" bolts. (See illustration No. 12).

To assemble the second rear wheel weight, remove two 5/8" x 5-3/4" bolts and insert two 5/8" x 3" bolts.

Tighten bolts securely. (See illustration No. 11).

I H C Part No.	Description
{ 6701 DA	Rear wheel weight, first.
{ 6701 DA	Rear wheel weight, second.

OPTIONAL REAR WHEEL PNEUMATIC TIRE EQUIPMENT FOR FARMALL-A AND B TRACTORS

I H C Part No.	
51281 D	Rear wheel rim with clamps (W6-24 rim for 9-24 tire).
.....	*Square head bolt, 5/8" x 2".
.....	Hex. nut, 5/8" N.C.
.....	Lockwasher, 5/8".
52873 D	Rear wheel rim with clamps (5.50R - 24 for 7.00-24 and 9.00-24 tire).
.....	*Square head bolt, 5/8" x 2".
.....	Hex. nut, 5/8" N.C.
.....	Lockwasher, 5/8".
56205 D	Rear wheel rim with clamps (W9-24 for 10-24 tire).
.....	*Square head bolt, 5/8" x 2".
.....	Hex. nut, 5/8" N.C.
.....	Lockwasher, 5/8".
56206 D	Rear wheel rim with clamps (W10-24 for 11-24 tire).
.....	*Square head bolt, 5/8" x 2".
.....	Hex. nut, 5/8" N.C.
.....	Lockwasher, 5/8".

* - 5/8" x 2-1/2" bolts are required on
FARMALL-A TRACTORS EQUIPPED WITH HEAVY R.H. REAR WHEEL
FARMALL-B TRACTORS EQUIPPED WITH HEAVY REAR WHEELS.

NOTE: When ordering rims, specify type of rear wheel tractor is equipped with.

When 10-24 or 11-24 size tire is used the minimum tread of 40" on Farmall-A and 66" on Farmall-B cannot be obtained.

HEAVY REAR WHEEL ATTACHMENT (58106 DA) (TWO USED) FOR FARMALL "B" TRACTORS

INSTALLATION - (See illustration No. 16).

Raise the rear end of tractor.

Remove six capscrews "A" and remove wheel rim and tire complete.

Remove four capscrews "B", cover "D", bolt "E" and pan "C".

Drive out shaft "F", using a rod approximately 1" in diameter. Be sure the rod is kept against the shaft so that the parts in rear axle housing will be kept in line.

Remove bearing from shaft and assemble on new shaft.

Reassemble the new shaft. Capscrews "E" must be inserted before driving shaft in position. Reassemble capscrews "B", cover "D" and pan "C".

Assemble new wheel on rim with tire, using four new bolts at "G", then assemble wheel complete on the axle shaft, using six new capscrews at "A".

NOTE: See regular Instruction Book for detail list of standard repair parts.

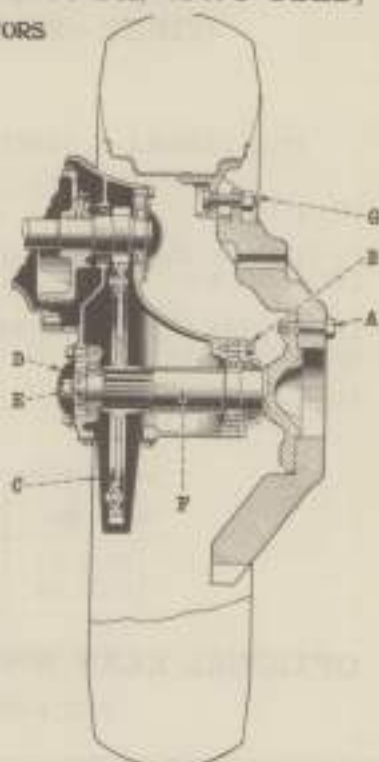
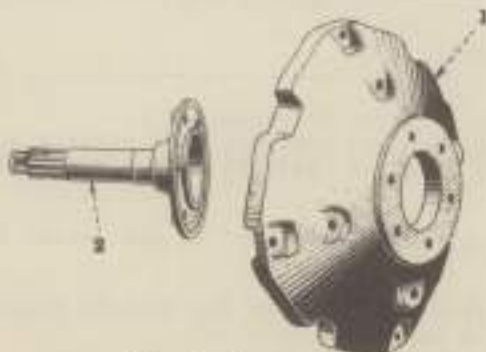

Illustration No. 16

View Showing Heavy Rear Wheel,
Assembled.

Ref. No.	I H C Part No.	Description
1	8529 D	Rear wheel.
...	Capscrew, 9/16" N.F. x 2-1/2".
...	Square head bolt, 5/8" x 2-1/2" (rim to wheel).
...	Hex. nut, 5/8" N.C. (rim to wheel).
...	Lockwasher, 5/8" (rim to wheel).
...	Lockwasher, 9/16".
2	57110 D	Rear axle shaft.
...	Capscrew, 5/8" N.F. x 1-1/4".
...	Lockwasher, 5/8".



5000 FT. ALTITUDE PISTON ATTACHMENTS

(GASOLINE OPERATION - 51189 D)
(KEROSENE OR DISTILLATE OPERATION - 53077 D)

(FOR FARMALL-A AND B TRACTORS)

I H C Part No.	Description
24416 DA	Piston ring (compression).
24434 D	Cylinder sleeve packing ring.
†32030 DA	Piston ring (oil control).
35493 D	Piston ring, taper (compression).
*43276 D	Piston ring (oil control).
*51189 D	Set of four cylinder sleeves with pistons.
*51361 D	Cylinder sleeve with piston.
†53077 D	Set of four cylinder sleeves with pistons.
53159 D	Piston pin.
†54282 D	Cylinder sleeve with piston.
35651 H	Piston pin retainer spring.

* - Attachment 51189 D Only (Gasoline Operation).

† - Attachment 53077 D Only (Kerosene or Distillate Operation).

8000 FT. ALTITUDE PISTON ATTACHMENTS

(GASOLINE OPERATION - 51188 D)
(KEROSENE OR DISTILLATE OPERATION - 53078 D)

(FOR FARMALL-A AND B TRACTORS)

I H C Part No.	Description
24416 DA	Piston ring (compression).
24434 D	Cylinder sleeve packing ring.
†32030 DA	Piston ring (oil control).
35493 D	Piston ring, taper (compression).
*43276 D	Piston ring (oil control).
*51188 D	Set of four cylinder sleeves with pistons, complete.
*51362 D	Cylinder sleeve with piston.
†53078 D	Set of four cylinder sleeves with pistons, complete.
53159 D	Piston pin.
†54281 D	Cylinder sleeve with piston.
35651 H	Piston pin retainer spring.

* - Attachment 51188 D Only (Gasoline Operation).

† - Attachment 53078 D Only (Kerosene or Distillate Operation).

NOTE: See regular I H C manual for illustrations of pistons, sleeves, etc.

RADIATOR SHUTTER ATTACHMENT (51419D)

(FOR FARMALL-A AND B TRACTORS)

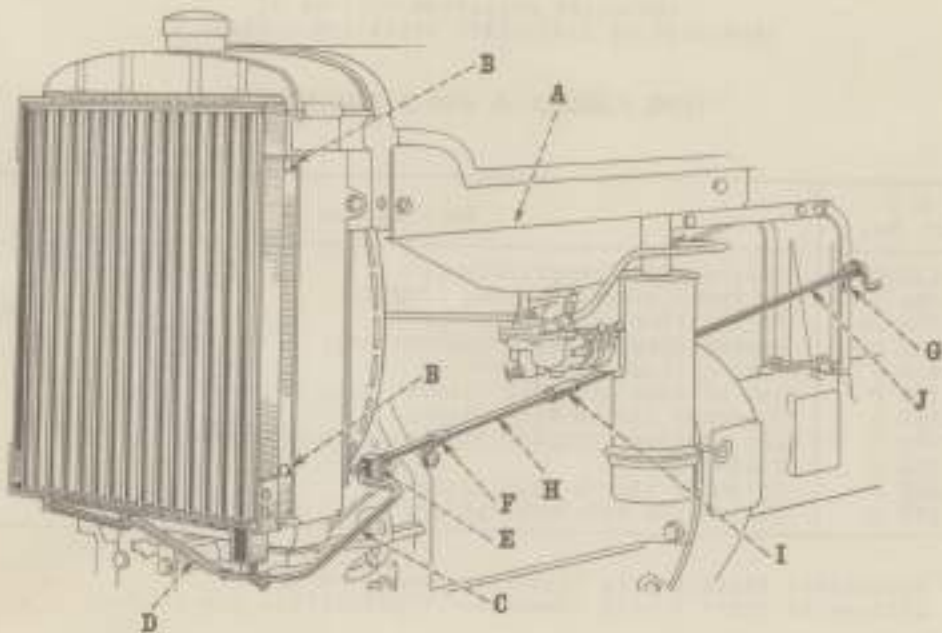

Illustration No. 18

View Showing Radiator Shutter Assembled

TO ASSEMBLE - See Illustration No. 18.

Remove radiator grille. Remove hood "A" and remove four fan housing sheet bolts "B".

Fasten shutter to radiator with the same four bolts.

Connect front control rod "G" with the bell crank "D" and control rod carrier "E".

Assemble the front bracket "F" and rear bracket "G".

Assemble center control rod "H", coupling "I" and rear control rod "J".

Replace radiator grille and hood.

NOTE: For Tractors with fuel tank support, rear (not drilled) it will be necessary to drill one $9/32$ " hole in left side of fuel tank support, rear, as shown in Illustration No. 19.

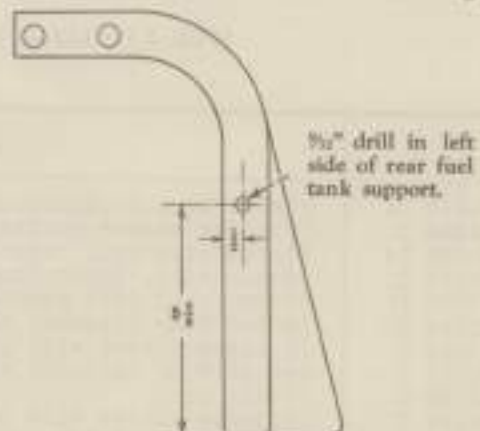

Illustration No. 19

View Showing Drilling Diagram for Fuel Tank Support, Rear. (For Tractors with Fuel Tank Support, rear not drilled).

RADIATOR SHUTTER ATTACHMENT (51419D) - Continued

TO ASSEMBLE HEAT INDICATOR

Remove two bolts from governor housing and assemble heat indicator with bracket, using the same bolts. (See illustration No. 20).

Remove old water inlet elbow and assemble new elbow, then assemble heat indicator tube.

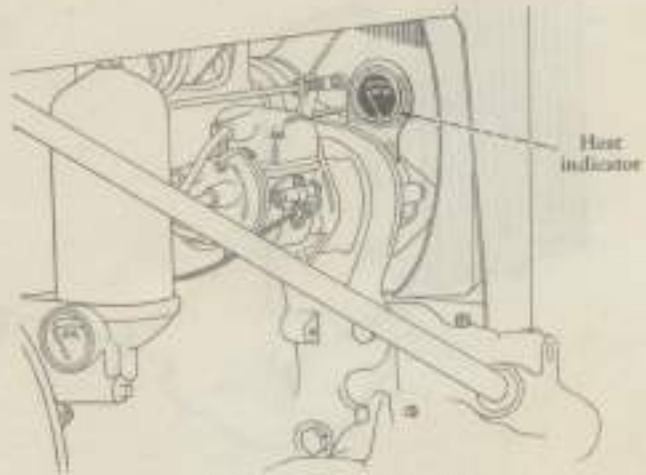

Illustration No. 20

View Showing Heat Indicator.

OPERATION

To assist in warming up a cold engine quickly, close the shutter completely (by turning control handle all the way to the left - counter-clockwise).

When heat indicator begins to show "Hot", open shutter just enough so as to maintain the operating temperature on the high side of the working range (on heat indicator). (See illustration No. 21).

Adjustment of shutter will vary according to tractor load, long periods of idling, or atmospheric temperature.

IMPORTANT: Do not start the engine in freezing weather without first closing the shutter completely.

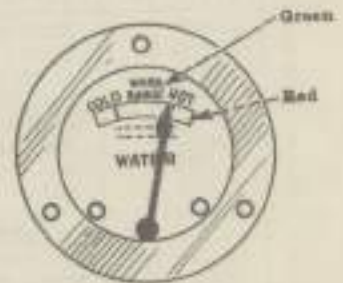

Illustration No. 21

Heat Indicator

RADIATOR SHUTTER AND HEAT INDICATOR ATTACHMENT (51419D) - Continued

(FOR FARMALL-A AND B TRACTORS)

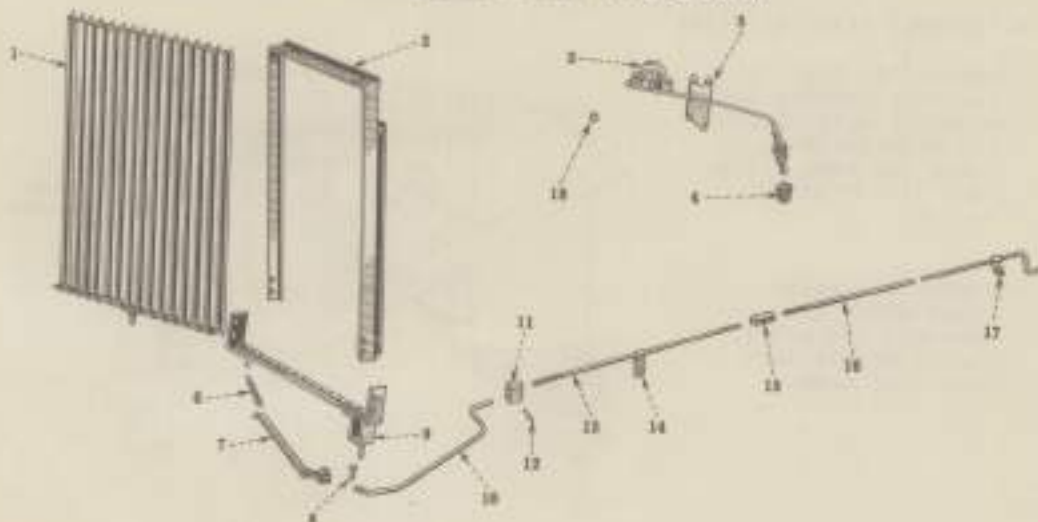

Illustration No. 22

Unnumbered parts in the illustrations are the same as corresponding parts shown with numbers.

Ref. No.	I H C Part No.	Description
...	51420 DR	Shutter, complete
1	53005 D	Shutter and bar assembly.
2	53008 D	Frame and bar assembly.
3	53619 D	Heat indicator.
4	61810 D	Reducing bushing.
5	53610 D	Bracket.
6	53004 D	Spring.
7	53007 D	Bell crank.
8	51427 D	Pin.
...	Washer, 17/64" I.D. x 5/8" O.D.
...	Cotter, 3/32" x 1/2".
9	53006 D	Bottom bar and bearing assembly.
10	51421 D	Rod, front.
11	61811 D	Control rod carrier.
12	36146 D	Pin.
13	52506 D	Rod, center.
...	Cotter, 3/32" x 3/4".
14	51423 D	Bracket, front.
...	Capscrew, 3/8" N.C. x 3/4".
...	Lockwasher, 3/8".
15	62507 D	Coupling.
...	Hex. nut, 5/16" N.C.
16	51422 D	Rod, rear.
...	Washer, 21/64" I.D. x 3/4" O.D.
...	Cotter, 3/32" x 3/4".
17	51424 D	Bracket, rear.
...	Capscrew, 1/4" N.C. x 5/8".
...	Hex. nut, 1/4" N.C.
...	Lockwasher, 1/4".
18	53031 D	Washer.
...	6764 DX	Water inlet elbow, complete.

When ordering, always use I H C Part Nos.

Don't order parts from the illustrations unless they are in the list also.

PNEUMATIC TIRE PUMPS (39604 D AND 39622 D)

(FOR FARMALL-A AND B TRACTORS)

PNEUMATIC TIRE PUMP (ENGINAIR) (39604 D)

(OPTIONAL WITH 39622 D)

I H C Part No.	Description
37886 D	Chrome ball, 5/16".
37887 D	Air chuck body.
37888 D	Air chuck cap.
37889 D	Air chuck rubber.
37890 D	Hose clamp ring.
37891 D	Hose (12 feet long).
37892 D	Hose (4 feet long).
37893 D	Gauge connection.
37895 D	Air gauge.
37896 D	Cloth bag.
40611 D	Barrel (18 MM.).
40613 D	Head.
40614 D	Spool.
40615 D	Strip valve.
40616 D	Hose nipple.
40617 D	Pumping element, complete (less hose and air chuck).

PNEUMATIC TIRE PUMP (SCHRADER) (39622D)

(OPTIONAL WITH 39604D)

I H C Part No.	Description
39626 D	Adapter.
42800 D	Shell.
42802 D	Rubber disc.
42803 D	Perforated plate.
42804 D	Rubber washer.
42805 D	Shank.
42806 D	Gauge connection.
42807 D	Hose (12 feet long).
42808 D	Hose (4 feet long).
42809 D	Dial gauge.
42810 D	Screw for adapter.
42811 D	Rubber washer (in adapter).
42812 D	Fibre washer (under perforated plate).
42813 D	Pump connection.
42859 D	Shell and hose.
58259 D	Hose connection, 5/16".

ADJUSTABLE FRONT AXLE ATTACHMENT (48290 DA)

(FOR FARMALL-A TRACTOR ONLY)

TO ASSEMBLE

Raise the front end of Tractor by placing jack under the left side of steering gear housing base "A". (See Illustration No. 24) (Also see Regular Instruction Book.

Disconnect the steering gear arm at "B" and remove steering knuckle arm "C", left hand and right hand, from steering knuckles "D" and tie rod ends "H".

Remove bolts at "E" (one from each side) from steering gear housing; base "A", spread the openings slightly and drive out the pivot shaft.

Remove old front axle complete.

Assemble old steering knuckles "D" through new axle and assemble old steering knuckle arms "C".

Line up the new front axle (with lubricator toward rear of tractor) with hole in steering gear housing base "A" and connect axle with housing base, using the old pivot shaft; then insert the two bolts and tighten securely. (See Illustration No. 24).

Front wheels should have $1/8$ " "toe-in" ($1/8$ " closer in front than rear), measurements being taken from the inside of front wheels.

To adjust "toe-in", disconnect steering knuckle arms "C" at "G", loosen lock nuts and turn tie rod ends "H" in or out as required.

Be sure to make arm adjustments equal. (See Illustration No. 23).

METHOD OF ADJUSTING FRONT AXLES

Remove axle extension clamps and remove bolts from tie rod clamps. Then move axle extension so that dowel holes coincide, obtaining desired positions,

Move tie rod to correspond with position of front axle extension.

Replace axle extension clamps and replace bolts in tie rod clamps, and tighten.

Six adjustments can be obtained at 4" increments which will give the following treads - 44", 48", 52", 56", 60" and 64", that will track accurately with the rear wheels.

(See regular Instruction Book for rear wheel adjustment).

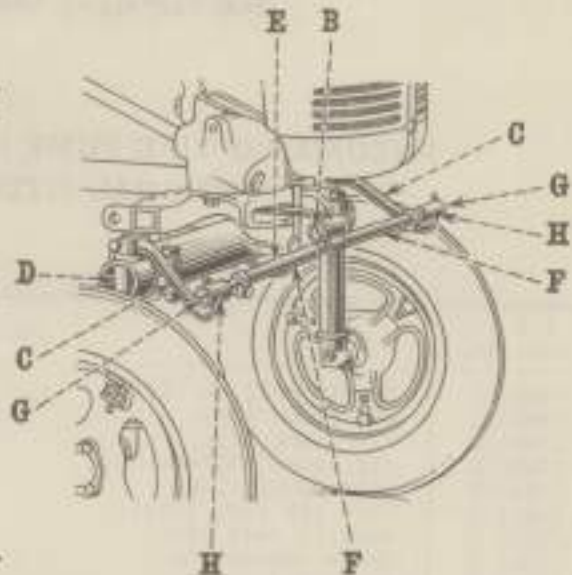

Illustration No. 23

View Showing Adjustable Front Axle Assembled.



Illustration No. 24

ADJUSTABLE FRONT AXLE ATTACHMENT (48290 DA) - Continued

(FOR FARMALL-A TRACTOR ONLY)

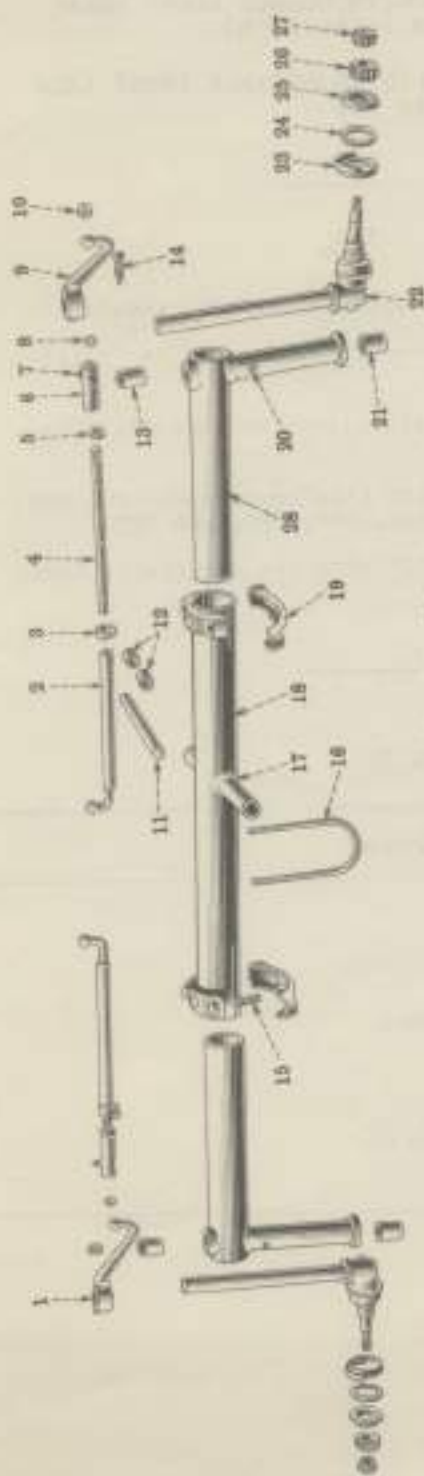

Illustration No. 25

Unnumbered parts in the illustrations are the same as corresponding parts shown with numbers

Ref. No.	I H C Part No.	Ref. No.	I H C Part No.	Ref. No.	I H C Part No.
1	*43464 DA	10	43470 D	18	45885 DAX
2	48289 DX	19	48287 DX
3	43747 D	11	...	20	Q 3615
...	...	12	*43456 DA	21	46340 D
...	...	13	43455 DA	22	*43460 DEX
...	...	14	46340 D
...
4	57139 DA	15	48628 D
5	23	*42462 D
6	48290 DX	24	*49118 DA
...	...	16	*46276 D	25	*43463 D
7	Q 3615	26	*54631 H
8	43465 D	27	*13823 V
9	*43465 DA	17	Q 3615	28	48286 DAX

Front axle.
Clamp.
Lubricator.
Bushings.
Steering knuckle.
Slotted hex nut,
5/8" N.F.
Washer, 1-1/4"
O.D. x 21/32" I.D.
Cotter, 1/8" x 1-1/4".
Dust shield.
Felt washer.
Oil seal.
Inner cone.
Outer cone.
Axle extension.

* Part of regular tractor.

When ordering, always use I H C Part Nos.

ADJUSTABLE FRONT WHEEL ATTACHMENT (57098 D)

FOR FARMALL-B TRACTORS EQUIPPED WITH DOUBLE FRONT WHEEL
ATTACHMENTS (55459 D or 55460 D)

FOR FARMALL-A TRACTORS EQUIPPED WITH ADJUSTABLE FRONT AXLE
ATTACHMENT (48290 DA)

INSTALLATION

Remove old front wheels and assemble new adjustable front wheels.

To adjust adjustable front axle, see instructions on page 18, illustration No. 23.

To adjust adjustable front wheels see instructions on page 31, illustration No. 25.

NOTE: When Attachment 57098 D is used with Attachment 48290 DA, the following additional treads can be obtained, 40", 68", and 70".

8.00 x 15 tires cannot be used on Model "A" with new adjustable front wheel in 40" tread position.

(See illustration No. 27).

Ref. No.	I H C Part No.	Description
3	55453 D	Felt washer.
5	54831 H	Inner bearing cone.
6	49117 D	Oil seal wear ring.
7	54630 H	Inner bearing cup.
8	5463E H	Inner bearing, complete.
9	8734 DX	Front wheel with bearing cups.
10	45440 D	Outer bearing cup.
11	13823 V	Outer bearing cone.
14	49116 D	Gasket.
16	57095 D	Rim.
...	Capscrew, 1/8" N.C. x 2-3/4".
...	Hex. nut, 1/2" N.C.
17	43441 D	Outer bearing, complete.

ADJUSTABLE FRONT WHEEL ATTACHMENT (57097 D) (FOR FARMALL "B" TRACTORS EQUIPPED WITH SINGLE FRONT WHEEL)

INSTRUCTIONS FOR ASSEMBLING

Raise front end of tractor, remove four nuts and lockwashers from front wheel stub shaft, and remove front wheel fork assembly, complete with wheel.

Assemble adjustable front wheels with pedestal to front wheel stub shaft, using four lockwashers and nuts.

CAUTION! Assemble pedestal with offset to rear, so that wheels trail.

LUBRICATION

When tractor is equipped with double front wheel, once every six (6) months, remove, clean and repack front wheels with pressure gun grease-chassis lubricant. (See illustration No. 28).

METHOD OF ADJUSTING

Three treads can be obtained with adjustable front wheels, beginning with wheels in narrow position, the tread is $8\text{-}7/8"$; for $8\text{-}7/8"$ tread, remove rims and turn each one around and reassemble with the lugs on the inside of wheels; for $12\text{-}7/8"$ tread (or wide position), remove rims and reassemble with lugs on the outside of wheels. (See illustration No. 26).

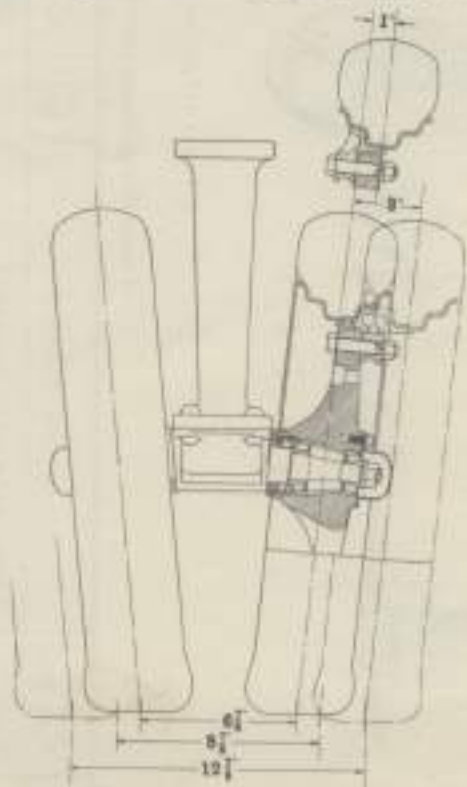

Illustration No. 26
View showing Adjustable Front Wheels.

ADJUSTABLE FRONT WHEEL ATTACHMENT (57097 D)

(FOR FARMALL-B TRACTORS EQUIPPED WITH SINGLE FRONT WHEEL)

Unnumbered parts in the illustrations are the same as corresponding parts shown with numbers

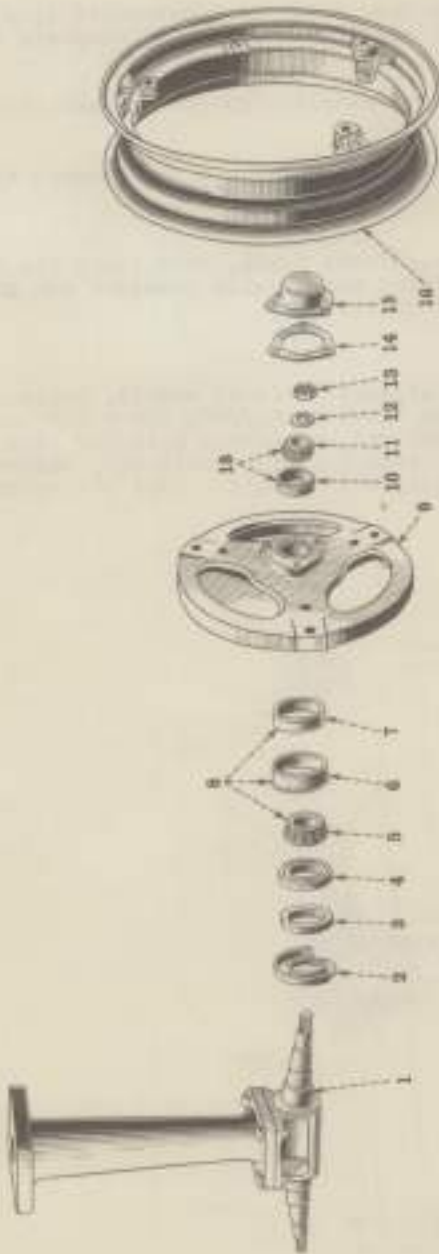

Illustration No. 27

When ordering, always use I H C Part Nos.

Ref. No.	I H C Part No.	Description	Ref. No.	I H C Part No.	Description
1	55461 D	Front axle with pedestal.	11	13823 V	Outer bearing cone.
..	Round head rivet, 1/8" x 1 1/2".	12	Washer, 21/32" I.D. x 1-1/4" O.D.
..	Cotter, 1/8" x 1-1/2".	13	5/8" S.F. Type "C" nut.
2	55454 D	Dust deflector.	14	49116 D	Gasket.
3	55453 D	Felt washer.	15	49115 D	Hub cap.
4	43463 D	Oil seal.	Cap screw, 5/16" N.C. x 5/8".
5	54621 H	Inner bearing cone.	Lockwasher, 5/16".
6	49117 D	Oil seal wear ring.	16	57035 D	Rim.
7	54620 H	Inner bearing cup.	Cap screw, 1/2" N.C. x 2-3/4".
8	54622 H	Inner bearing, complete.	Hex. nut, 1/2" N.C.
9	5734 DX	Front wheel with bearing cups.	17	43441 D	Outer bearing, complete.
10	43440 D	Outer bearing cup.			

Don't order parts from the illustrations only; refer to the list also.

GREASING FRONT WHEEL

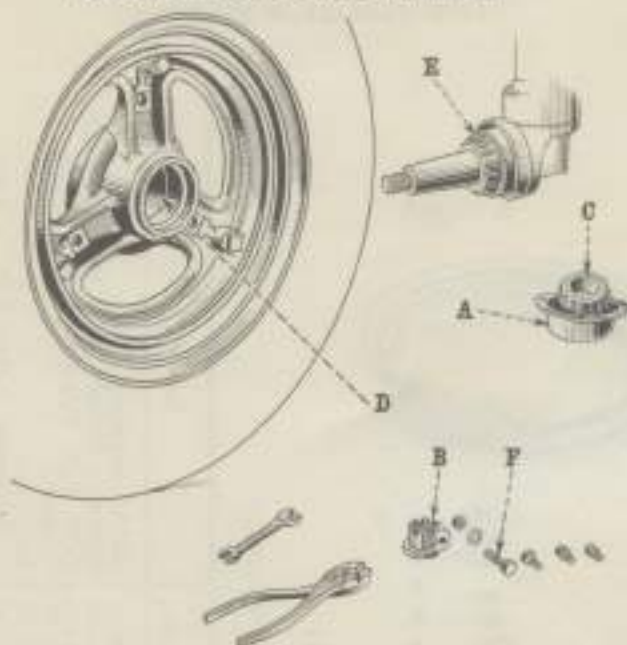

Illustration No. 28
Method of Greasing Front Wheels.

FRONT WHEELS - GREASING - (See illustration No. 28).

To grease front wheels, jack up the front axle until the wheel clears the ground. Remove hub cap "A", loosen bolt "F" and remove nut "B". Remove bearing "C" and place in hub cap "A" or clean container; then remove wheel. Clean inside of hub "D" and repack with pressure gun grease (chassis lubricant).

Remove old grease from bearings and clean with kerosene.

It is advisable to leave bearing "E" on the axle and clean with a brush and kerosene. Apply new grease on rollers before reassembling bearings.

Reassemble wheel, tighten nut "B" until wheel binds slightly, rotating wheel at the same time. Back nut off one castellation from the cotter pin hole; replace cotter pin and tighten bolt "F".

Be sure to keep all parts clean.

DOUBLE FRONT WHEEL ATTACHMENT (55460 D)

(FOR FARMALL-B TRACTORS)

INSTRUCTIONS FOR ASSEMBLING

Raise front end of tractor, remove four nuts and lockwashers from front wheel stub shaft, and remove front wheel fork assembly, complete with wheel.

Assemble double front wheels with pedestal to front wheel stub shaft, using four nuts and lockwashers.

CUTION! Assemble pedestal with offset to rear, so that wheels trail.

LUBRICATION (See illustration No. 28)

When tractor is equipped with double front wheels - once every six (6) months, remove, clean and repack front wheels with pressure gun grease (chassis lubricant).

DOUBLE FRONT WHEEL ATTACHMENT (55460 D) - Continued

(FOR FARMALL-B TRACTORS)

Unnumbered parts in the illustrations are the same as corresponding parts shown with numbers.



Illustration No. 29

When ordering, always use I H C Part Nos.

Ref. No.	I H C Part No.	Description	Ref. No.	I H C Part No.	Description
1	55461 D	Front axle with pedestal.	11	13883 V	Outer bearing cone.
...	Round head rivet, 1/2" x 2".	12	Washer, 21/32" I.D. x 1-1/4" O.D.
...	Cotter, 1/8" x 1-1/2".	13	5/8" N.F. Type "C" nut.
2	55454 D	Dust deflector.	14	49116 D	Gasket.
3	55253 D	Felt washer.	15	49115 D	Hub cap.
4	43463 D	Oil seal.	Capscrew, 5/16" N.C. x 5/8".
5	54631 H	Inner bearing cone.	Lockwasher, 5/16".
6	49117 D	Oil seal wear ring.	16	31453 D	Rim.
7	54630 H	Inner bearing cup.	17	48976 DA	Clamp.
8	54632 H	Inner bearing, complete.	Square head bolt, 1/2" x 5-1/4".
9	6787 DCX	Front wheel with bearing cups.	Hex. nut, 1/2" N.C.
10	43460 D	Outer bearing cup.	18	43441 D	Outer bearing, complete.

Don't order parts from the illustrations only; refer to the list also.

BELT PULLEY

The gear shift lever must be in neutral position when operating belt pulley.

Throttle down engine to low idle speed; disengage clutch and move power take-off gear shift lever back until gears are in mesh, then slowly engage clutch.

When not in use belt pulley should be removed from tractor and the exposed shaft should be covered with pulley shaft guard.

POWER TAKE-OFF

TO OPERATE POWER TAKE-OFF WITH TRACTOR IN MOTION

Throttle down engine to low idle speed; disengage the clutch and move power take-off gear shift lever back until gears are in mesh, shift transmission gears to the speed that is desired to run the tractor, then slowly engage clutch. The power take-off is started and stopped by the same clutch as the tractor. Therefore, be sure to disengage clutch before moving the power take-off gear shift lever.

TO OPERATE POWER TAKE-OFF WITH TRACTOR STANDING STILL

The gear shift lever must be in a neutral position.

Throttle down engine to low idle speed; disengage the clutch and move power take-off shift lever back until gears are in mesh, then slowly engage clutch.

When power take-off is not in use, cover shaft with power take-off shaft guard.

BELT PULLEY ATTACHMENT - (S6082D)

(For Farmall-A and B Tractors already Equipped
with a Power Take-Off Attachment)

TO ASSEMBLE

Back off small slotted pipe plug on right hand side of power take-off housing as far as possible without removing it. This releases the power take-off, engaging and disengaging poppet.

Remove upper four (4) bolts of Power Take-Off Attachment and withdraw power take-off cover assembly.

Remove power take-off shifter tube and assemble it on drive shaft of new Belt Pulley Attachment.

Assemble belt pulley drive housing gasket.

Insert Belt Pulley Attachment, using two of the four removed bolts as guides. Before inserting very far, engage the operating lever throw-out pin in the grooved sleeve of the shifter tube assembly; then push the Belt Pulley Attachment into position, and tighten up the four (4) bolts previously removed.

Tighten the slotted pipe plug, thus setting the engaging and disengaging poppet.

Fill belt pulley housing with approved lubricant. (See Lubrication Instructions, page 27). (Also see Instruction Book).

NOTE: When power take-off shaft is not in use, it should be covered with power take-off shaft guard, Item 19, Illustration No. 34. When Power Take-Off Attachment is used, assemble shield "D" as shown in Illustration No. 31.

LIST OF REPAIR PARTS

(See Illustration No. 31)

Ref. No.	I H C Part No.	Description	Ref. No.	I H C Part No.	Description
1	43670 D	Plug.	26	48094 D	Retainer.
2	58638 D	Shaft (23 teeth).	Capscrew, 3/8" N.C. x 1".
...	Capscrew, 7/16"x1".	Lockwasher, 3/8".
...	Lockwasher, 7/16".	Shim, light.
3	63441 H	Bearing, inner.	38	47884 D	Shim, medium.
4	48084 D	Gasket.	39	47265 D	Shim, heavy.
5	48089 D	Oil trough.	40	47886 D	Bearing cage.
6	43684 D	Gear (17 teeth).	41	47881 D	Gasket.
7	7225 T	Key.	43	47283 D	Retainer, complete.
8	52866 D	Shaft.	44	48085 DAX	Capscrew, 3/8" N.C. x 1-1/4".
...	Capscrew, 7/16" N.F. x 1".	Lockwasher, 3/8".
...	Lockwasher, 7/16".	Oil seal.
18	0614 DAX	Housing, complete.	Spacer.
...	Capscrew, 7/16"x1-1/4".	45	48954 D	Spacer.
...	Lockwasher, 7/16".	46	43630 D	Spacer.
...	Ctnk. plug, 1".	48	48087 D	Guard, complete.
...	Plug, 1/8".	49	54001 DX	Pulley (5 1/2" diameter x 5" face).
19	47284 D	Shim, light.	50	6257 D	Shield (See Illustration No. 31).
20	47285 D	Shim, medium.	Capscrew, 3/8" N.C. x 7/8".
21	47286 D	Shim, heavy.	Lockwasher, 3/8".
22	43262 DA	Washer.	Power take-off drive housing stud.
23	43631 D	Gear pinion (19 teeth).	Hex. nut, 7/16" N.C.).
24	47281 D	Bearing cage.	Lockwasher, 7/16".
...	ST E12	Bearing, outer (optional with 48848 VA).	
25	48848 VA	Bearing, outer (optional with ST E12).	

BELT PULLEY AND POWER TAKE-OFF ATTACHMENT (48104 DA)

(FOR FARMALL-A AND B TRACTORS)

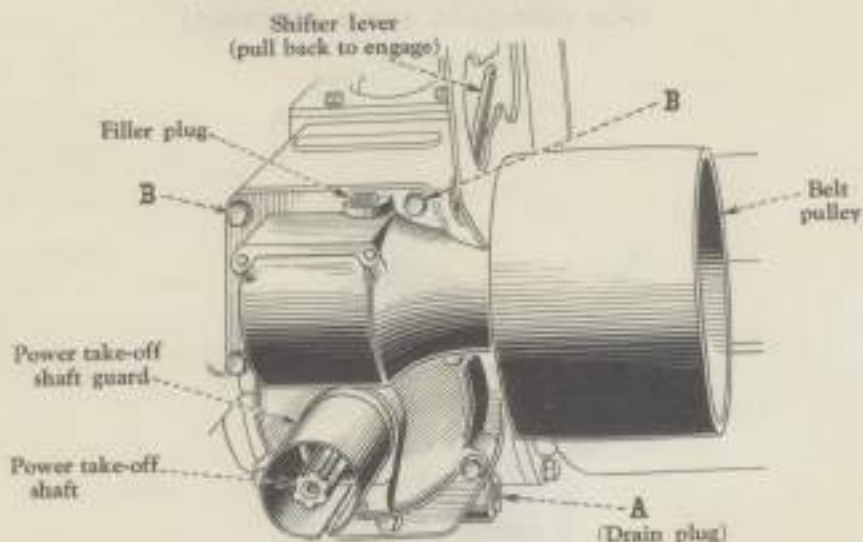

Illustration No. 30

View of Belt Pulley and Power Take-off Attachment Assembled on Tractor.

INSTRUCTIONS FOR ASSEMBLING

Drain transmission case at "A" (See Illustration No. 30).

Remove rear transmission cover plate.

Remove nuts from the four belt pulley housing bolts.

Remove the two upper bolts "B" completely, and insert 3/8" rods approximately 8" long for a guide.

Assemble power take-off drive shaft housing gasket.

Assemble belt pulley and power take-off complete, using the rods to hold housing in place on rear of transmission case, and as a guide for the power take-off drive shaft.

After housing is placed in correct position, insert lower studs. Assemble the first nuts on studs "C". (See Illustration No. 32). Remove the two rods and insert original bolts, and be sure they are tight. Turn the pulley by hand before starting engine.

NOTE: When the belt pulley attachment is not in use the pulley can be removed and the exposed shaft covered with spacer and pulley shaft guard, (Items 48 and 49 - Illustration No. 31).

NOTE: When power take-off shaft is not in use, it should be covered with power take-off shaft guard, (Item 49 - Illustration No. 34).

When power take-off attachment is used, assemble shield "D" using two nuts at "C" as shown in Illustration No. 32.

Pulley speed is 1158 RPM. Belt speed with 8-1/2" diameter pulley is 857 1/2 feet per minute.

LUBRICATION

To insure proper lubrication of new parts, fill reservoir in belt pulley housing with approved transmission lubricant (approximate capacity - 1 U.S. pint), after which proper level is maintained from oil in transmission case.

Refill transmission case with approved lubricant, capacity approximately 6 U.S. quarts.

See Instruction Book for location of transmission filler and level plugs, - also for specifications of approved lubricant.

BELT PULLEY AND POWER TAKE-OFF ATTACHMENT

(48104 DA) - Continued
 (FOR FARMALL-A AND B TRACTORS)

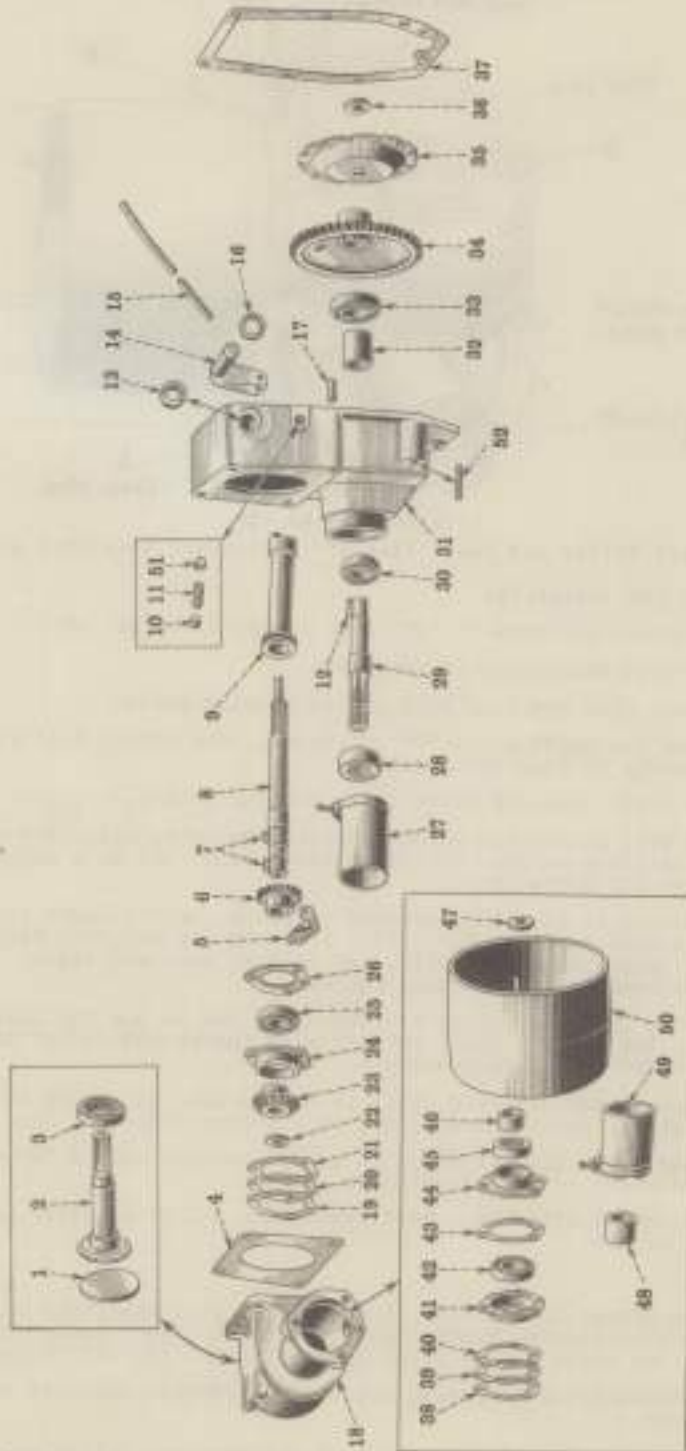

Illustration No. 31

Unnumbered parts in the illustrations are the same as corresponding parts shown with numbers.

BELT PULLEY AND POWER TAKE-OFF ATTACHMENT (48104 DA) - Continued (FOR FARMALL-A AND B TRACTORS)

Unnumbered parts in the illustrations are the same as corresponding parts shown with numbers.

Ref. No.	I H C Part No.	Description	Ref. No.	I H C Part No.	Description
1	43070 D	Plug.	29	48091 DA	Shaft.
2	52832 D	Shaft (23 teeth).	Capacrew, 7/16" N.F. x 1".
...	...	Capacrew, 7/16" N.F. x 1".	Lockwasher, 7/16".
...	...	Lockwasher, 7/16".	30	ST 213	Bearing (optional with 53874 D).
3	43441 H	Bearing, inner.	30	53874 D	Bearing (optional with ST 213).
4	48084 D	Gasket.	31	6615 DX	Housing, complete.
5	48089 D	Oil trough.	Capacrew, 7/16" N.C. x 3".
6	48254 D	Gear (17 teeth).	Capacrew, 7/16" N.C.x1-1/4".
7	7225 T	Key.	Lockwasher, 7/16".
8	52826 D	Shaft.	32	48026 D	Spacer.
...	...	Capacrew, 7/16" N.F. x 1".	33	ST 213	Bearing (optional with 53874 D).
...	...	Lockwasher, 7/16".	33	53874 D	Bearing (optional with ST 213).
9	52825 D	Shifter.	34	48090 D	Gear (44 teeth).
10	48103 D	Poppet.	35	48093 D	Oil sling.
11	48103 D	Spring.	36	43262 DA	Washer.
12	13552 D	Key.	37	46061 DA	Gasket.
13	43545 D	Felt washer.	38	47284 D	Shim, light.
14	53517 D	Shifter lever shaft.	39	47285 D	Shim, medium.
...	...	Cotter, 5/32" x 1-1/4".	40	47286 D	Shim, heavy.
15	53515 D	Shifter lever.	41	47281 D	Bearing cage.
16	...	Washer, ES/32 I.D. x 1-1/4" O.D.	42	ST 212	Bearing (optional with 42842 VA).
17	17581 D	Dowel.	43	47283 D	Bearing (optional with ST 212).
18	6514 DAX	Housing, complete.	44	48085 DAX	Gasket.
...	...	Capacrew, 7/16" N.C. x 4-1/4".	Retainer, complete with oil seal.
...	...	Lockwasher, 7/16".	45	48954 D	Capacrew, 3/8" N.C. x 1-1/4".
...	...	Ctk. head plug, 1".	Lockwasher, 3/8".
...	...	Plug, 1/8".	45	48954 D	Oil seal.
19	47284 D	Shim, light.	46	43630 D	Spacer.
20	47285 D	Shim, medium.	47	43262 DA	Washer.
21	47286 D	Shim, heavy.	48	48087 D	Spacer.
22	43262 DA	Washer.	49	54001 DX	Guard, complete.
23	43631 D	Gear pinion (19 teeth).	50	8837 D	Pulley, 8-1/2" dia. x 3" face.
24	47281 D	Bearing cage.	51	...	Slotted head plug, 1/4".
...	...	Bearing, outer (optional with 42842 VA).	Shield, complete (See illustration #0. 32).
25	42842 VA	Bearings, outer (optional with ST 212).	...	56398 D	Capacrew, 3/8" N.C. x 7/8".
26	48094 D	Retainer.	Lockwasher, 3/8".
...	...	Capacrew, 3/8" N.C. x 1".	54	55402 D	Power take-off drive housing stud.
...	...	Lockwasher, 3/8".	Hex. nut, 7/16" N.C.
27	51494 DX	Guard, complete.	Lockwasher, 7/16".
28	48114 D	Oil seal.

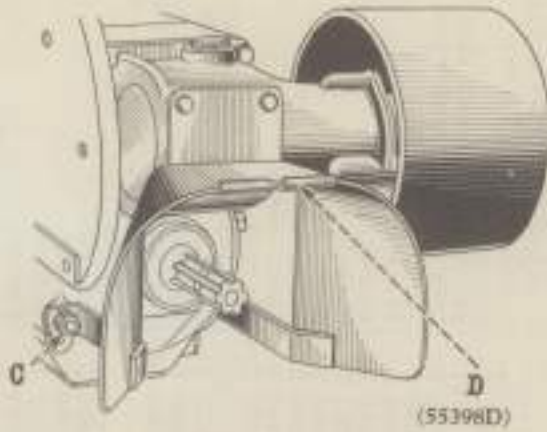

Illustration No. 32

View Showing Shield Assembled on Belt
Pulley and Power Take-Off Attachment.



Illustration No. 33

View Showing Shield Assembled on Power
Take-Off Attachment

POWER TAKE-OFF ATTACHMENT (48153 DA)

(FOR FARMALL-A AND B TRACTORS)

INSTRUCTIONS FOR ASSEMBLING

Drain transmission case.

Remove rear transmission cover plate.

Remove nuts from the four bolts holding power take-off cover and housing intact.

Remove the two upper bolts "B" completely, and insert 3/8" rods, approximately 8" long.

Assemble power take-off drive housing gasket.

Assemble power take-off complete, using the rods to hold housing in place on rear of transmission case, and as a guide for the power take-off drive shaft.

After housing is placed in correct position, insert lower studs. Assemble the first nuts on studs "F" (see illustration No. 33). remove the two rods and insert original bolts, and be sure they are tight. Rotate power take-off shaft by hand before starting engine.

NOTE: When the power take-off shaft is not in use it should be covered with power take-off shaft guard (Item 19, illustration No. 34).

When Power Take-Off attachment is used, assemble shield "E" using two more nuts at "C" as shown in illustration No. 33).

LUBRICATION

Refill transmission case with approved lubricant. Capacity approximately 6 U.S. quarts.

See Instruction Book for location of filler and level plugs, also for specifications of approved lubricant.

POWER TAKE-OFF ATTACHMENT (48153 DA) - Continued

(FOR FARMALL-A AND B TRACTORS)

Unnumbered parts in the illustrations are the same as corresponding parts shown with numbers

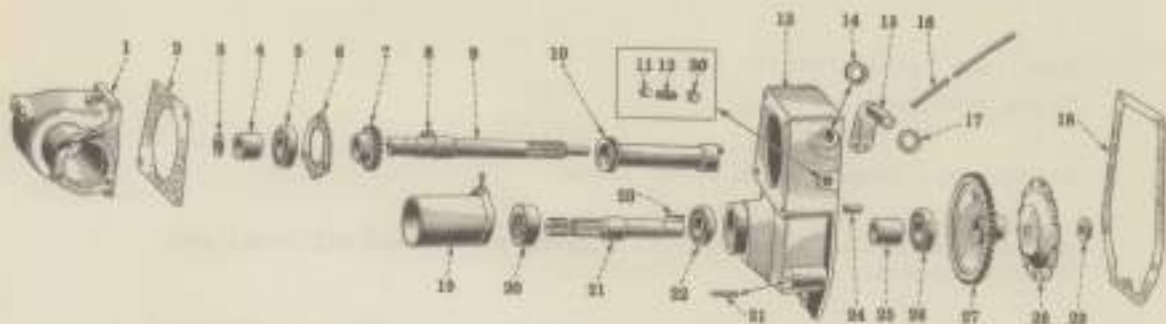

Illustration No. 39

When ordering, always use I H C Part Nos.

Ref. No.	I H C Part No.	Description	Ref. No.	I H C Part No.	Description
1	6629 DA	Cover.	16	53515 D	Shifter lever.
...	Capscrew, 7/16" N.C. x 4-1/4".	17	Washer, 1-25/32 I.D. x 1-1/4" O.D.
...	Lockwasher, 7/16".	18	48061 DA	Gasket.
2	48064 D	Gasket.	19	51484 DX	Guard, complete.
3	43262 DA	Washer.	20	48114 D	Oil seal.
4	48152 D	Spacer.	21	48091 DA	Shaft.
...	ST 212	Bearing (optional with 42842 VA).	Capscrew, 7/16" N.F. x 1".
5	42842 VA	Bearing (optional with ST 212).	...	ST 213	Lockwasher, 7/16".
6	48094 D	Retainer.	...	ST 213	Bearing (optional with 23874 D).
...	Capscrew, 3/8" N.C. x 3/4".	22	23874 D	Bearing (optional with ST 213).
...	Lockwasher, 3/8".	23	13552 D	Key.
7	43684 D	Drive pinion (17 teeth).	24	17581 D	Dowel.
8	7225 T	Key.	25	48092 D	Spacer.
9	52666 D	Shaft.	...	ST 213	Bearing (optional with 23874 D).
...	Capscrew, 7/16" N.F. x 1".	26	23874 D	Bearing (optional with ST 213).
...	Lockwasher, 7/16".	27	48090 D	Gear (44 teeth).
10	52668 D	Shifter.	28	48093 D	Oil slinger.
11	46102 D	Poppet.	29	43262 DA	Washer.
12	48103 D	Spring.	30	Slotted head plug, 1/4".
13	6615 DX	Housing, complete.	31	55402 D	Power take-off drive housing stud.
...	Capscrew, 7/16" N.C. x 3".	Hex. nut, 7/16" N.C.
...	Capscrew, 7/16" N.C. x 1-1/4".	Lockwasher, 7/16".
...	Lockwasher, 7/16".	...	55402 D	Shield (See Illustration No. 33).
...	Slotted head plug, 1/4".	Capscrew, 3/8" N.C. x 7/8".
14	43645 D	Felt washer.	Lockwasher, 3/8".
15	53517 D	Shifter lever shaft.			
...	Cotter, 5/32"x1-1/4".			

Don't order parts from the illustrations only; refer to the list also.

**DOUBLE GROOVE FAN AND GENERATOR PULLEY HUB
(28318 DX)**

FAN COMPLETE WITH DOUBLE PULLEY HUB (28821 DA)

(See detail list of Repair Parts below).

NOTE: Attachments 28318 DX must be applied with all Attachments unless Tractor is already so equipped.

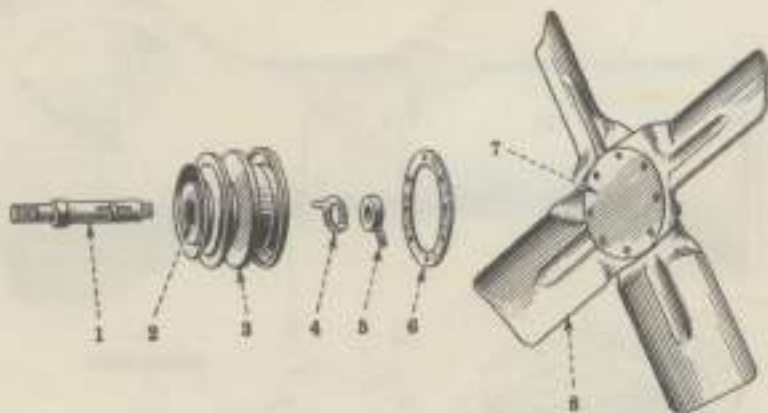

Illustration No. 35

Unnumbered parts in the illustrations are the same as corresponding parts shown with numbers.

Ref. No.	I H C Part No.	Description
*...	28821 DA	Fan, complete with double pulley hub.
*1	25957 D	Spindle.
*2	11155 V	Cork washer.
3	28318 D	Fan hub.
*4	12470 VA	Washer.
*5	62786 VX	Nut.
6	11154 VA	Gasket.
*7	32985 D	Plate.
*8	{ 32984 D	Blade assembly.
	{ 32984 DX	Blade assembly with plate.

* - Used on Attachment 28821 DA Only.

When ordering, always use I H C Part Nos.

Don't order parts from the illustrations only; refer to the list also.

FLYWHEEL RING GEAR ATTACHMENT (86618D)

(MUST BE APPLIED WITH ALL STARTING ATTACHMENTS
UNLESS TRACTOR IS ALREADY SO EQUIPPED.)

(FOR FARMALL-A AND B TRACTORS)

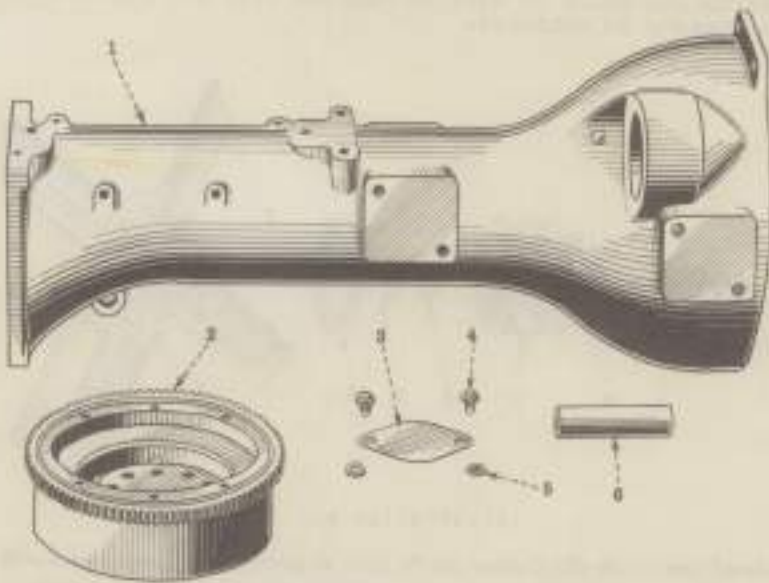

Illustration No. 36

Ref. No.	I H C Part No.	Description
1	8638 DX	Clutch housing.
...	No. 4 tapered cork, 7/16" x 5/8" - 13/18" long.
2	6402 DCX	Flywheel with ring gear.
3	48554 D	Starter pad cover.
4	Cap screw, 1/2" x 5/8" N.C.
5	Lockwasher, 1/2".
6	43846 D	Clutch release sleeve guide.

When ordering, always use I H C Part Nos.

Avoid Accidents



Most accidents, whether they occur in industry, on the farm, at home, or on the highway, are caused by the failure of some individual to follow simple and fundamental safety rules or precautions. For this reason most accidents can be prevented by recognizing the real cause and doing something about it before the accident occurs.

Regardless of the care used in the design and construction of any type of equipment, there are many conditions that cannot be completely safeguarded against without interfering with reasonable accessibility and efficient operation.



A careful operator is the best insurance against an accident.

The complete observance of one simple rule would prevent many thousand serious injuries each year. That rule is: "Never attempt to clean, oil, or adjust a machine while it is in motion."



NATIONAL SAFETY COUNCIL



Order Genuine Parts for Replacements





Satisfactory and efficient service in the operation of this or any other machine is endangered by the use of inferior repairs, as cheap parts invariably mean short life and high cost.





If parts could be manufactured at a lower cost and sold at lower prices without sacrificing quality, this would be done. The right material for the purpose and the knowledge acquired through many years of manufacturing enables International Harvester Company to produce quality that will not be found in imitation repairs.

Inferior repair parts are sold for IHC machines, but you take an unnecessary risk when you buy them.



Our customers should remember that whenever they find repairs furnished are not as **GOOD** as the parts on a New IHC Machine, they are **NOT** getting **GENUINE** parts.



Buying "will fit" parts to save money is like stopping the clock to save time.

